



A TREASURE OF FERTILITY PROSPERITY AND
A LAND OF ABUNDANT RESOURCES!

+918586866824

A TREASURE OF FERTILITY, PROSPERITY AND
A LAND OF ABUNDANT RESOURCES!



RAHEJA
aramya
INDEPENDENT FLOORS



A TREASURE OF FERTILITY PROSPERITY AND
A LAND OF ABUNDANT RESOURCES!

+918586866824



Aranya as in Vedic literature is wilderness;
a bountiful forest, a treasure of fertility, prosperity and
a land of abundant resources.

Nature has the power to enlighten humanity, to unwind the senses and
to escort lives to an organic living that is beyond routines.
Proximity to nature, the feeling of getting reconnected to ones inner self and
an idea to prosper is all that calls for Aranya Independent Floors,
an integral part of Aranya Green City.

Aranya Independent Floors driven by an exceptional idea of luxurious living
is here to nestle the young and the energetic,
the passionate and the zealous to live a life extended holiday.

Entangled in the aroma of a colonial world,
Aranya – Independent Floors is standing amidst the green environs
of Sohna tucked at the foothills of Aravallis in the Aranya city.

Aranya, a passion of luxury is an abode to experience spirituality
in its full swing, an abode to experience adventure and
an abode to relax and rejuvenate.

RAHEJA
aranya
INDEPENDENT FLOORS

FROM
THE HOUSE OF

 **RAHEJA™**

India's Best Developer

Best Developer Worldwide

India's Most Awarded Developer

First to deliver and Launch projects
in both Gurgaon and Sohna
Master plans 2031

OUR ICONIC PROJECTS

THE TALLEST IN HARYANA



REVANTA

THE TALLEST IN DELHI

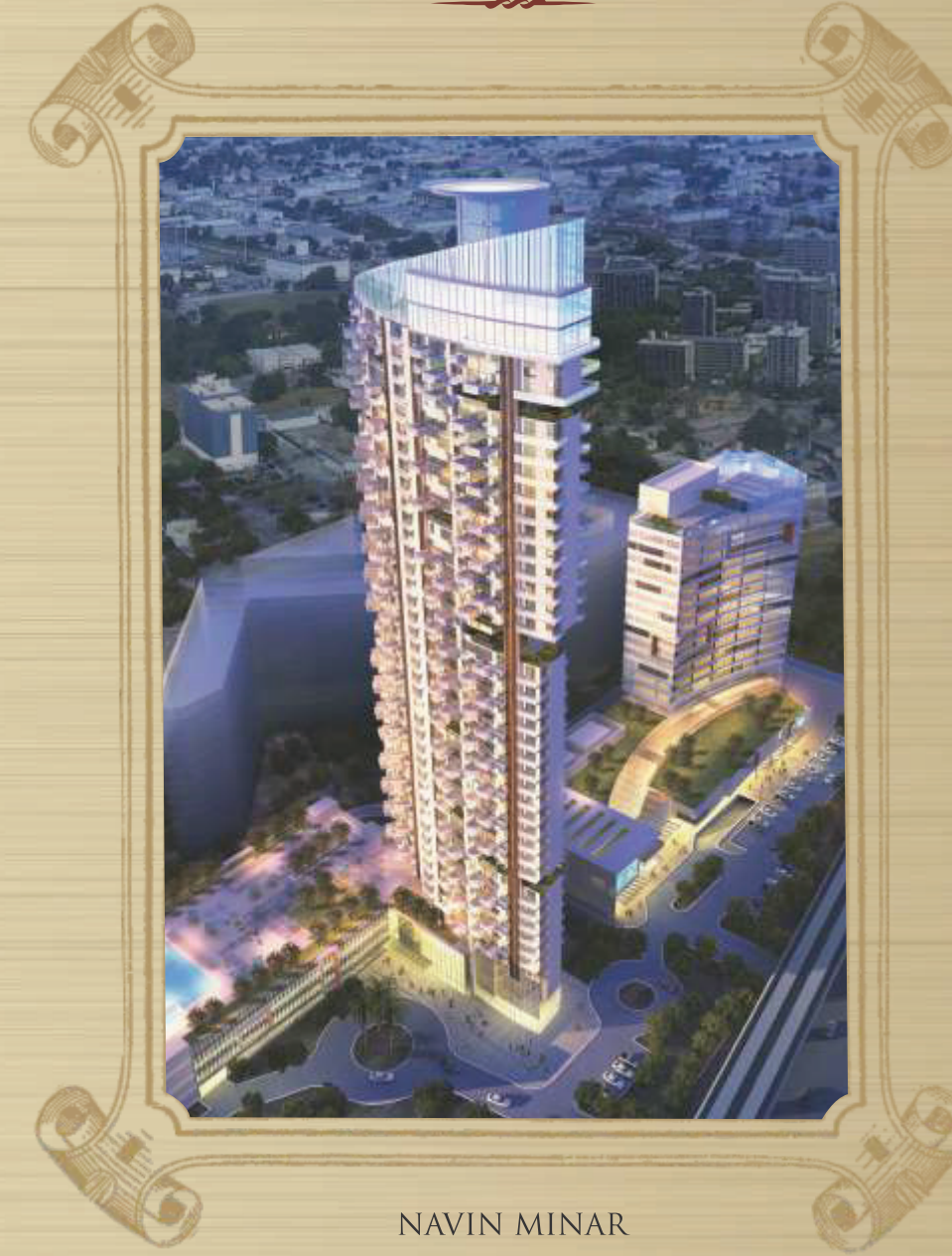

NAVIN MINAR

THE TALLEST ON A NATIONAL HIGHWAY



OMA



MUMBAI INTERNATIONAL AIRPORT - CRAFTED BY L&T



BURJ KHALIFA - WORLD'S TALLEST BUILDING - CRAFTED BY ARABTEC

INFRASTRUCTURE BY



Larsen and Toubro

CONSTRUCTION BY



Arabtec
Arabtec Construction,
LLC (UAE)

OUR CONTRACTORS

*Developer reserves the right to replace contractors depending on work progress for betterment of project.

PART OF
RAHEJA ARANYA,
INDIA'S MODEL
SMART GREEN CITY

Spread over 165 acres, Aranya City is probably the only city in Delhi-NCR offering views of Aravallis on all sides, it consists of double layer Concrete Roads, Solar LED Lighting for the entire city, Schools, Dispensaries, Shopping Centre, Hotels, Community Centre, Old Age Homes, Shopping Complexes as well as Nature friendly green features like Water Harvesting etc. Surrounded by nature, yet close to civilization, Aranya is truly a destination.



+918586866824



INFRASTRUCTURE
DEVELOPMENT BY L&T
(LARSEN AND TOUBRO)



SURROUNDED BY
THOUSANDS OF ACRES
OF ARAVALLIS

Aravallis, one of the ancient mountain ranges in India, home to a diverse range of flora & fauna and expansive lakes, stretches from Rajasthan to Delhi are considered the lungs of the region. These floors standing in front of magnificent mountain ranges will be favored by whistling winds, gentle clouds, lush green tabletops, sun kissed mornings and the vibrant shades of twilight.

+918586866824

A VERDANT STORY OF NATURE WOVEN IN
THE STRINGS OF
BRITISH ERA



AN ERA OF STYLE, AN ERA OF DIGNITY,
AN ERA OF PASSION AND
AN ERA OF STATE OF ART LIVING.

INTRODUCING ARANYA – INDEPENDENT FLOORS

The well planned Ground+3 floors reflects the astounding features and architectural details of British architecture. The buildings are designed to offer independent floor to each unit thereby adding to the grandeur of living in a lifestyle apartment.



RAHEJA
ARANYA
INDEPENDENT FLOORS

+918586866824



THE ARCHITECTURE - SKETCH OF BRITISH ERA

The British architecture reflects in its outer look; the sloping tiled roofs, the open balconies, the open spaces in and out and lavish open to sky courtyard. Aranya, a secured gated community with lavish gardens, tree lined walkways, theme parks, community halls, sports complex and high end lifestyle blocks reveal the Colonial ways of living.

The upscale residential blocks intend to attract the genre who wants to enjoy life, who wants to feel the thrill and those who wants to go beyond the daily routines to enjoy the British era. Aranya - the structure is specifically designed to meet the requirements of a certain genre of the society. The bold outlook and leisure amenities of the residential blocks in Aranya City makes it first choice for a second home.

Aranya is a 3 & 4 BHK lifestyle apartments for you to choose from 3 different designs. It is a residential community of 38 plots offering 114 units spread over Ground +3 floors, one unit on each floor.

+918586866824



AN ERA OF STYLE, AN ERA OF DIGNITY,
AN ERA OF PASSION AND
AN ERA OF STATE OF ART LIVING!

THE ATTRIBUTES

Aranya residential blocks at Sohna stand apart in its category for its excellent and amicable features. The features that makes Aranya a home away from home are incredible and they will attract its people to have frequent visits to their well panned weekend homes and unwind their senses. The facilities at Aranya floors are both unit based and community based.

UNIT BASED FACILITIES

- Located in Aranya city at close proximity of Residential areas of South of Gurgaon
- Ground +3 floors blocks having 114 units in total
- Tree lined community with beautifully landscaped gardens in the premise with parks
- Provision for servant quarter with each unit
- Provision of parking for 2 vehicles per unit
- Passenger lifts
- Large utility balcony
- Ideas for better home automation that mainly includes pre installed wifi system*
- Installation of Eco friendly solar system*

*Optional packages subject to extra charges

COMMUNITY BASED FACILITIES

- In close proximity to office complex, dispensary, nursing home and schools(Nursery, primary and high school)
- Close access to shopping street
- Well connected to community clubhouse

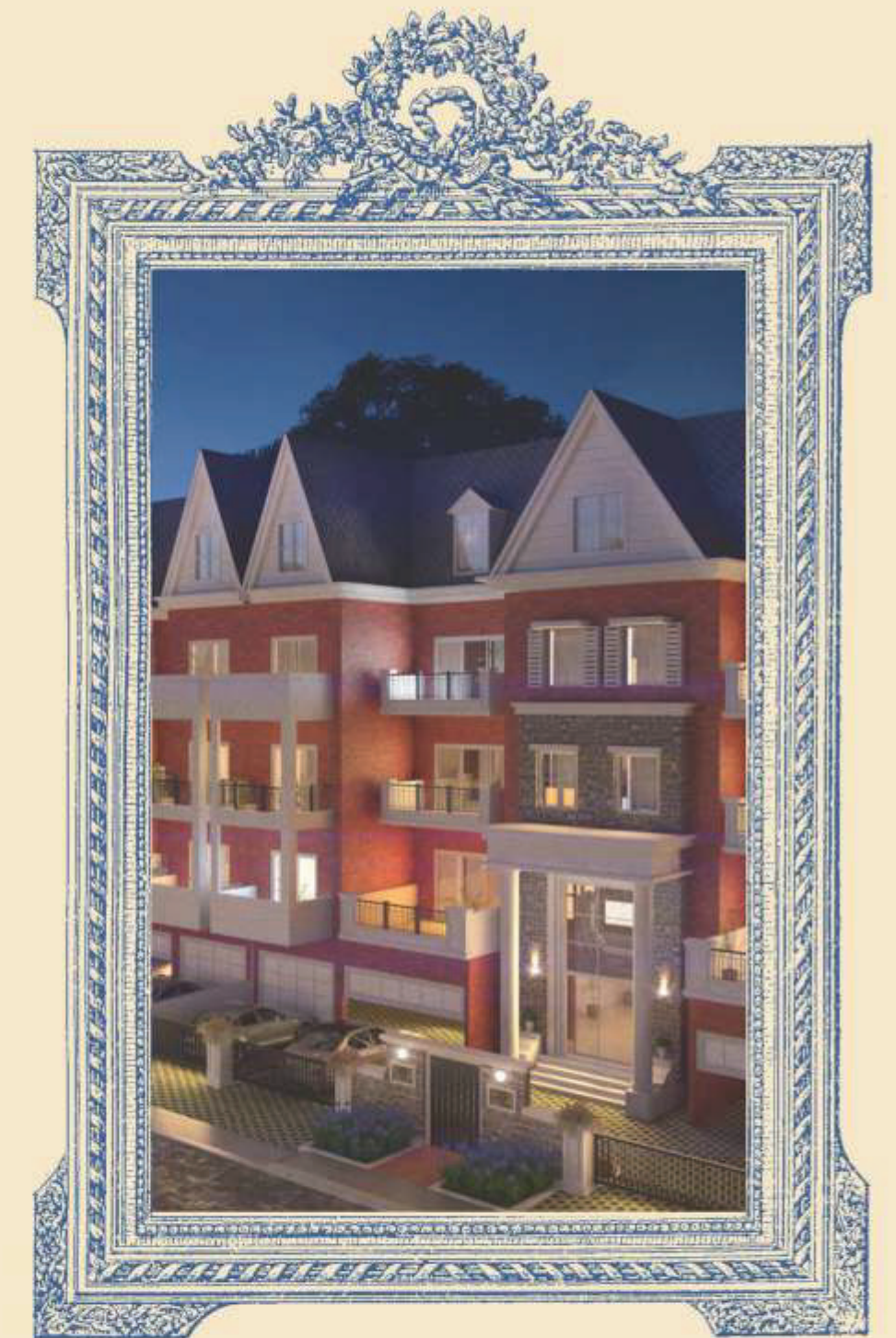

THE ARCHITECTURE -

PORTRAIT FROM COLONIAL TIME

+918586866824



THE OPULENCE



A GRAND LIVING WITH AN EXHILARATING LIFESTYLE



- One floor one unit, a real sense of luxury that is ahead than the regular apartments in city
- Open to sky courtyard gives it a feel of more open spaces inside and outside the apartment that is usually found in bungalows.

A private green backyard for the units on 1st floor



- A private green backyard for the units on 1st floor in each block makes it the first choice for people who enjoy greens and are looking for a private garden.



Private open terrace with a backdrop of Aravallis for the units on 3rd floor

- The units on 1st floor comes with basement, a great idea for people who are looking forward to utilize basement for variety of purposes like to plan a personal gym, to plan a home theatre, to plan a party area or to use as an extra storage space

- Provision for a private plunge pool or a jacuzzi in the backyard of the units on 1st floor in each block is a great parameter of luxe and style*

Basement for variety of purposes like a home theatre



- The 2nd floor units comes with all basic modern lifestyle amenities that matches well with desire of people who want to plan a small yet amicable weekend home.

Provision for a private plunge pool



- The units on 3rd floor comes with rights to develop a private landscaped garden, a high end idea to add opulence to apartment living. The units are first choice of people looking for extra private open spaces with a backdrop of Aravallis that is most suitable for those terrace parties. The serene and soothing environs gels well with theme terrace gatherings, a time to enjoy a glass of wine with a surge cool breeze beneath the stary skies amidst the serene environment.

+918586866824

*Optional packages on extra cost

THE ADVENTURE

@ ARANYA *in* SOHNA

For the first time in India, we have introduced adventure activities on a scale never before experienced under one roof :

- Go Karting
- ATV - All Terrain Vehicle Obstacle Course
- Ziplining
- Zorbing
- Adventure Camp
- Hot Air Ballooning and Paramotoring & many others



All Terrain Vehicle



Go Karting



Zorbing

+918586866824



WEEKEND GATEAWAY

Aranya located in Sohna, an address to serene residences has so much to offer in and around 2500 acres of green belt and open spaces. Aranya is well addressed with cool breeze, open blue skies, tall green trees, gazing wildlife and enchanting beauty of hills. An address that is all set to offer a weekend home that is away from the hustle and bustle, a place to enjoy weekend with your near and dear ones.



Sulphur Springs With close proximity to Sohna's famous Sulphur Lakes



Bird Watching At the foothills of Aravallis, one of the oldest mountain ranges of India offers dense vegetation makes the visit of wild animals & Birds around the premise



Damdama Lake Close to Damdama lake, one of the most popular lakes in Haryana and a favored picnic spot

+918586866824

THE IDEA FOR BETTER LIVING

Aranya - Independent Floors offers tree lined jogging tracks for a healthy start of day when away from hectic routines. The community is further planned with green cycling belts across the Aranya green city in the backdrop of green vegetation and enchanting Aravallis.

The community has a facility of central club house and sports complex. The facilities like spa sohna and swimming pool will add to the health regime for all age groups.



THE CONVENIENCES

Inspired by the young and energetic, blessed by the experienced and inhabited by all ages, Aranya is a better place to enjoy life at the fullest. With every need in close vicinity, Aranya is a perfect gateway for families with varied needs.

The lifestyle blocks are in close proximity of shopping mall, retail outlets and offices. The facilities of grocery store, ATM and pharmacy are made available on the premises itself. The banks, health centre, hospitals and taxi stand are at walking distance. The development is well connected to leisure spots like cafes, restaurants and multiplex. The internal walkways are planned for better connectivity within Aranya green city.



Club House



Hospitals



Shopping Malls



Office Spaces



Restaurants



International Schools

RAHEJA
ARANYA
INDEPENDENT FLOORS

+918586866824

FLOOR PLANS



+918586866824

TYPE A

TYPE A (PLOT NO. A6), Plot Size: 827.80 sq.yd.
 A6 - FF - 8481.96 sq.ft.
 SF - 3408.23 sq.ft.
 TF - 4562.67 sq.ft.
 Building Plan approval No. 781 of 23/12/14

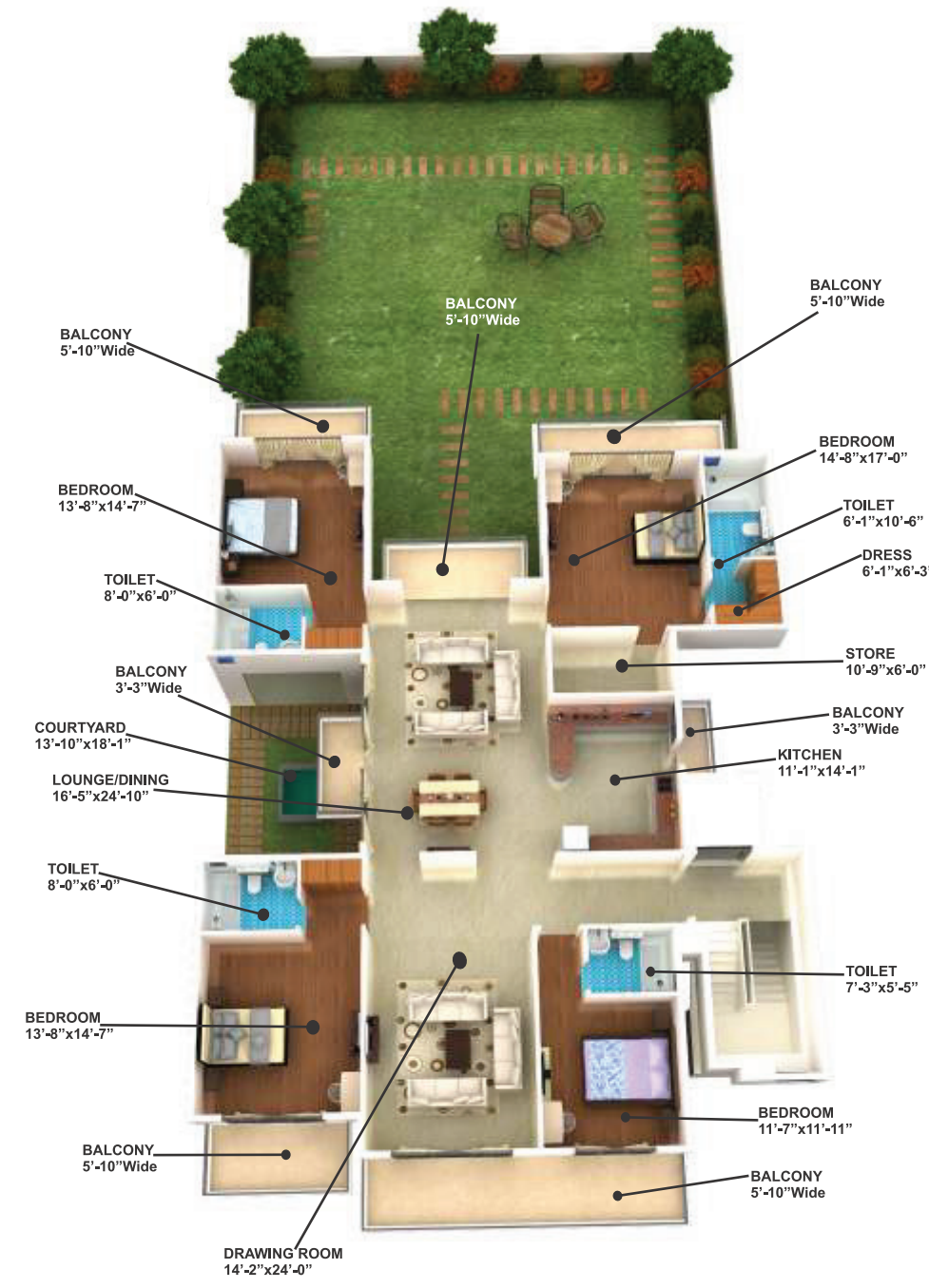

TYPE A

TYPE A (PLOT NO. A7), Plot Size: 744.89 sq.yd.
 A7 - FF - 7718.56 sq.ft.
 SF - 3129.27 sq.ft.
 TF - 4190.17 sq.ft.
 Building Plan approval No. 769 of 23/12/14

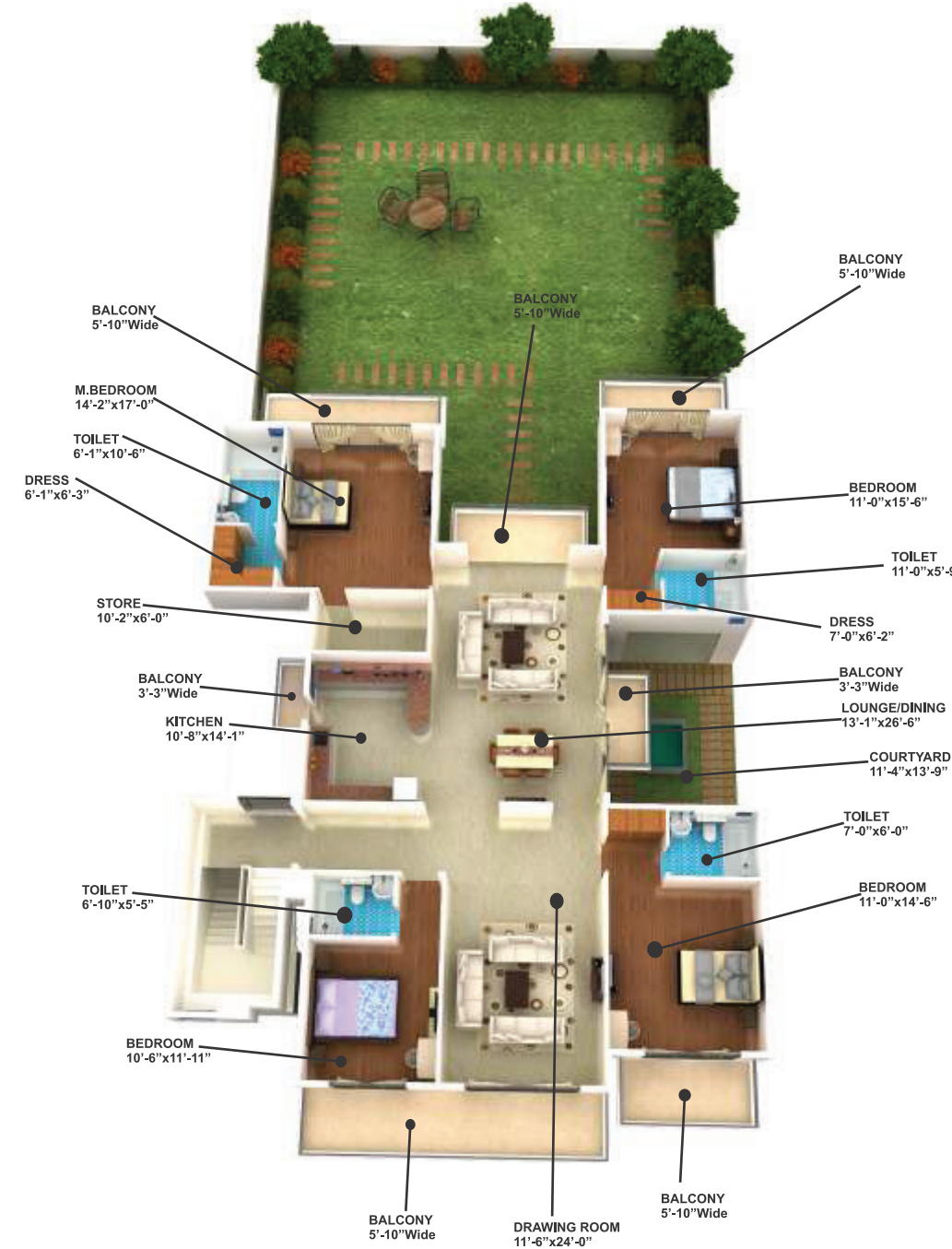

TYPE D

TYPE D (PLOT NO. D155), Plot Size: 379.29 sq.yd.
 D155 - FF - 4398.55 sq.ft.
 SF - 2064.03 sq.ft.
 TF - 2676.93 sq.ft.
 Building Plan approval No. 775 of 23/12/14



Disclaimer: Raheja Developers Ltd. (Company) reserves the right to make changes as per the prevailing government norms. All approvals can be checked at the office of the Company. The Company expressly disclaims any express or implied warranty of accuracy and assumes no liability for any errors and/or omissions of any information mentioned herein. Images shown in the brochure are pictorial conceptualization and representation only and it is an attempt to replicate the exact product; however, the actual product may differ. Also, this Brochure shall not constitute any legal offer. All the site plans, areas, dimensions, specifications, perspective view, floor plans, facilities and amenities are tentative in nature and the information and contents provided herein are subject to change as per Company's discretion without any prior notice. Home furnishings, furniture and gadgets are not a part of offerings. Please contact Company for any clarification whatsoever.

Note: The licence no. 25 of 2012 of 29.03.2012 has been granted to Residential for area ad-measuring 107.85 Acres and 19 of 2014 dated 11.06.2014 for an area ad-measuring 57.68125 Acres respectively. Total Area 165.531 Acres. Layout plans approved. Type of colony and its area: Residential plotted, Commercial and Group Housing in 107.85 Acres and 57.68125 Acres, respectively. Building plans approved through various memos issued from time to time developed by Company.

TYPE D

TYPE D (PLOT NO. D156-160), Plot Size: 382.31 sq.yd.
 D156 -160 - FF - 4429.52 sq.ft.
 SF - 2077.86 sq.ft.
 TF - 2696.52 sq.ft.
 Building Plan approval No. 778 of 23/12/14



TYPE D

TYPE D (PLOT NO. D169-177), Plot Size: 394.47 sq.yd.
 D169 - 177 - FF - 4506.70 sq.ft.
 SF - 2129.37 sq.ft.
 TF - 2763.91 sq.ft.
 Building Plan approval No. 772 of 23/12/14

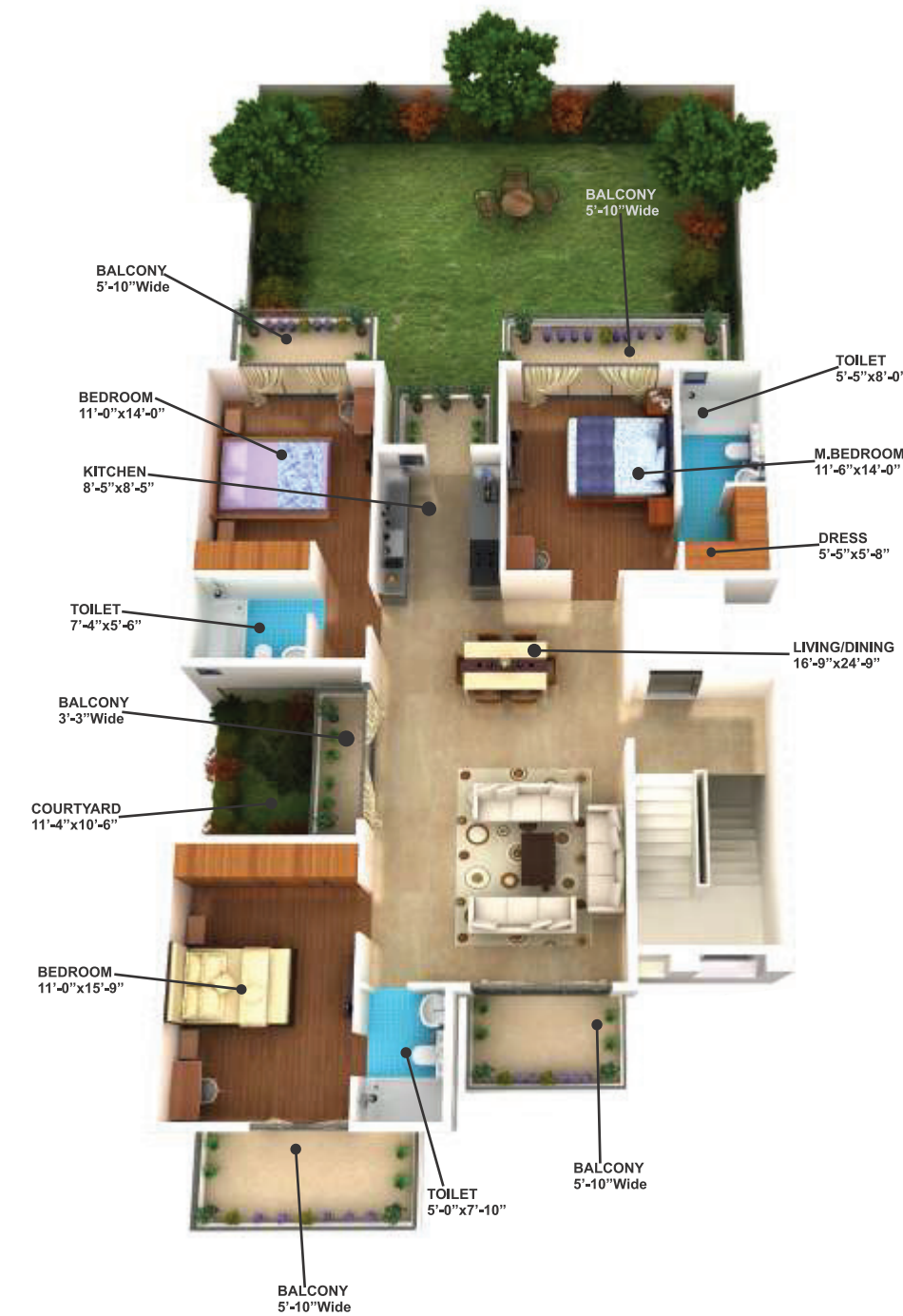

TYPE E

TYPE E (PLOT NO. E 87-97), Plot Size: 290.88 sq.yd.
 E87 - 97 - FF - 3485.25 sq.ft.
 SF - 1716.71 sq.ft.
 TF - 2204.05 sq.ft.
 Building Plan approval No. 763 of 23/12/14

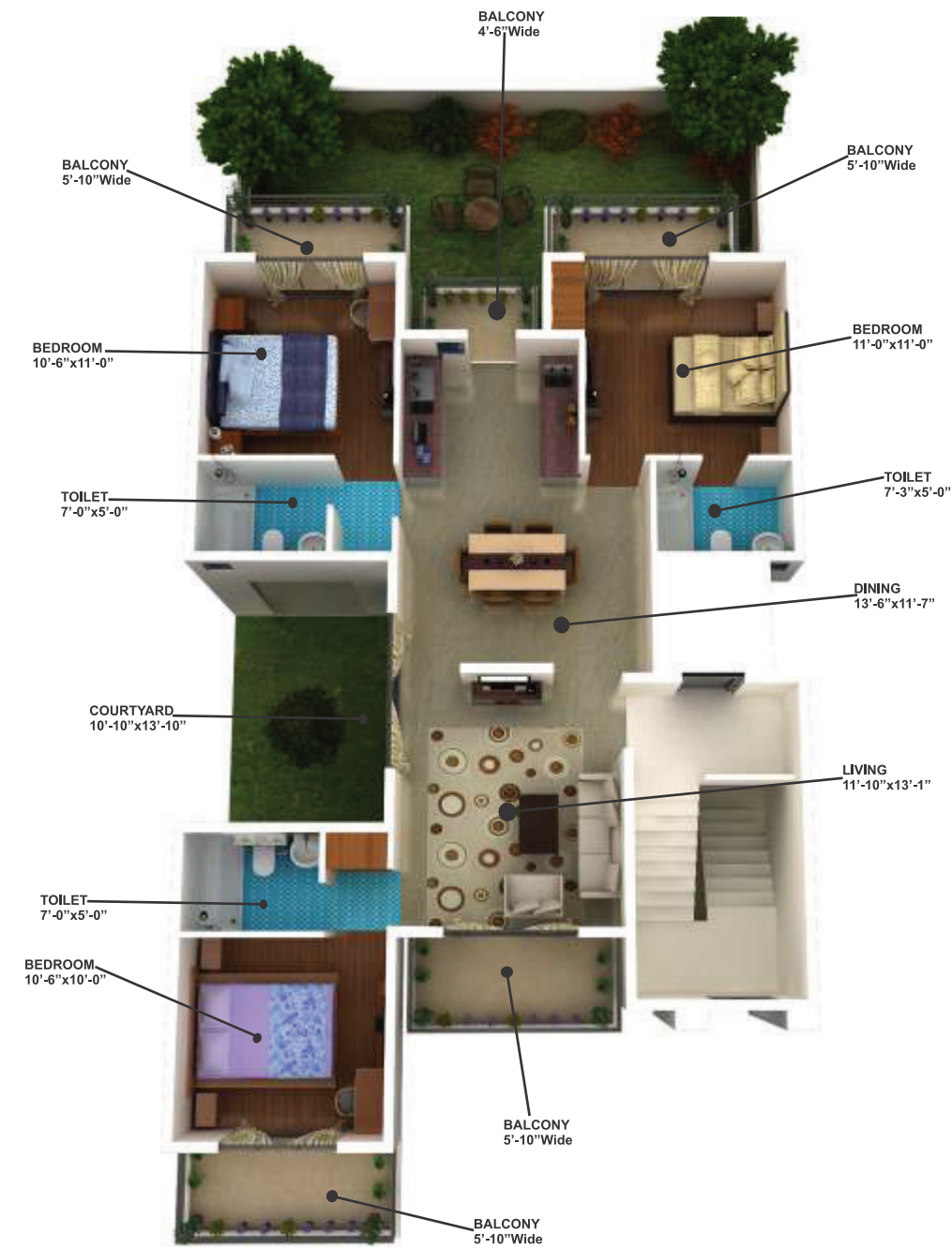

TYPE E

TYPE E (PLOT NO. E99_108), Plot Size: 284.80 sq.yd.
 E99 - 108 - FF - 3434.23 sq.ft.
 SF - 1694.10 sq.ft.
 TF - 2169.66 sq.ft.
 Building Plan approval No. 766 of 23/12/14

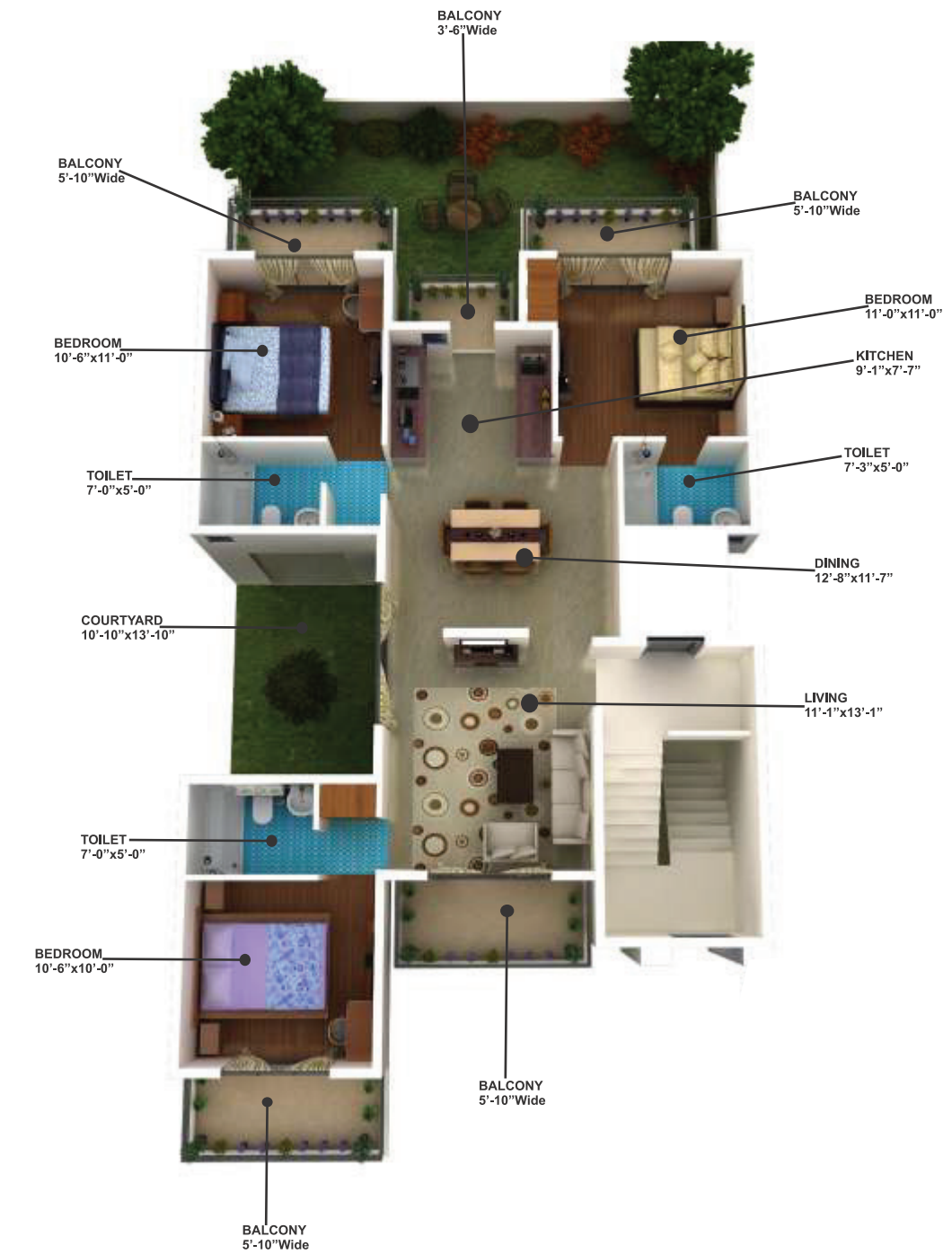

+918586866824

Disclaimer: Raheja Developers Ltd. (Company) reserves the right to make changes as per the prevailing government norms. All approvals can be checked at the office of the Company. The Company expressly disclaims any express or implied warranty of accuracy and assumes no liability for any errors and/or omissions of any information mentioned herein. Images shown in the brochure are pictorial conceptualization and representation only and it is an attempt to replicate the exact product; however, the actual product may differ. Also, this Brochure shall not constitute any legal offer. All the site plans, areas, dimensions, specifications, perspective view, floor plans, facilities and amenities are tentative in nature and the information and contents provided herein are subject to change as per Company's discretion without any prior notice. Home furnishings, furniture and gadgets are not part of offerings. Please contact Company for any clarification whatsoever.

Note: The licence no. 25 of 2012 of 29.03.2012 has been granted to Residential for area ad-measuring 107.85 Acres and 19 of 2014 dated 11.06.2014 for an area ad-measuring 57.68125 Acres respectively. Total Area 165.531 Acres. Layout plans approved, Type of colony and its area: Residential plotted, Commercial and Group Housing in 107.85 Acres and 57.68125 Acres, respectively. Building plans appved through various memos issued from time to time developed by Company.

RAHEJA™ HONORS



Raheja Developers Limited are accredited with over 100 awards on national as well as global podium from some of the most credible agencies. Some of them are :

- CNBC Awaaz Crisil Real Estate Award
- Cityscape Asia Award
- Asia Pacific Bloomberg Google Property Award
- OPP(London) Excellence Award
- Zee Business RICS Award
- Golden Peacock Award
- EUROMONEY Award for Best Developer in India for three consecutive years 2011, 2012 and 2013 and many more...

TRANSPARENCY@RAHEJA

At Raheja, we pride ourselves in always implementing new and innovative processes to keep you updated about your property. Join us on Facebook, YouTube or our continuously updated website to watch the latest construction update videos, virtual tours, new product offerings and newsfeeds from anywhere in the world or while on the move. We also take pride in being one of the few real estate companies to run on specially developed ERP software which provides accountability and transparency in process.

Every Raheja customer gets a unique username and password to his account. What it means for you is that you can always be aware of the present construction status of your property and your account statements. Demand letters are sent along with latest photographs and only after uploading the latest construction update videos on Youtube which is accessible at the touch of a button while you relax at home.

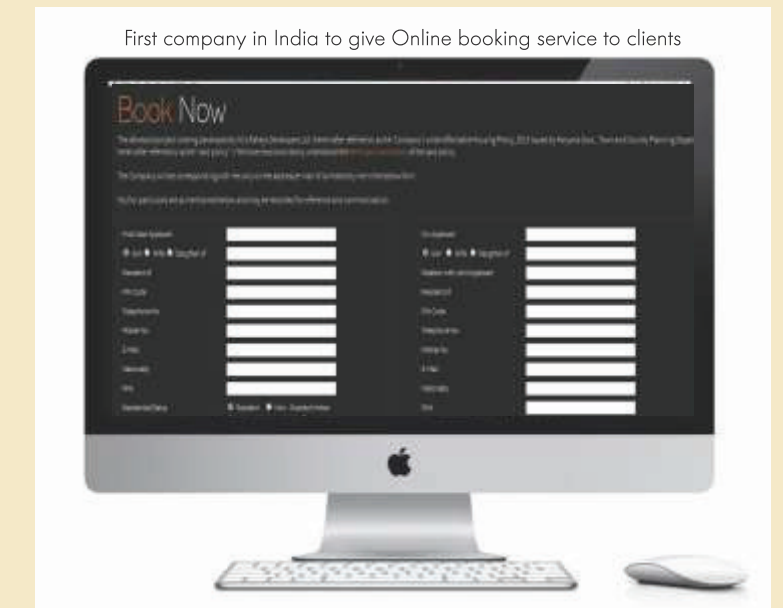
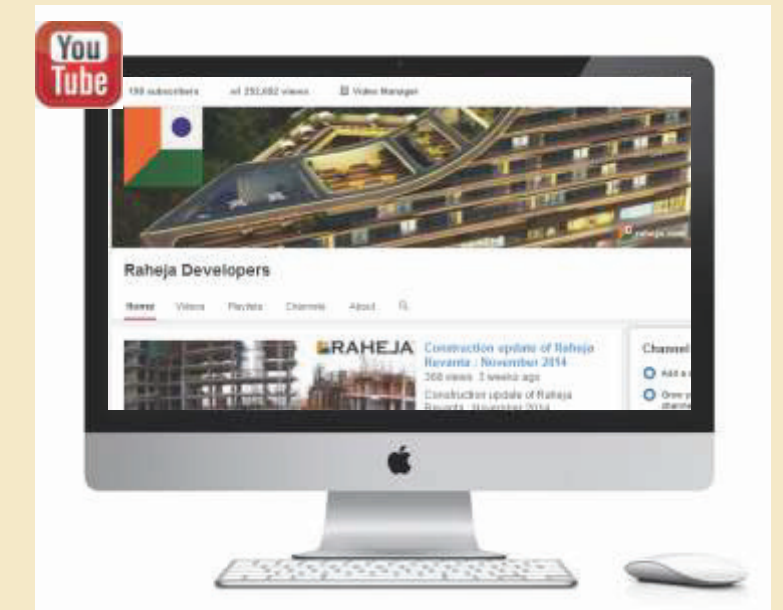

+918586866824

OUR PROJECTS

IMPECCABLE QUALITY AND
DELIVERY RECORD SINCE
OVER 25 YEARS.



RAHEJA ATLANTIS (Built)

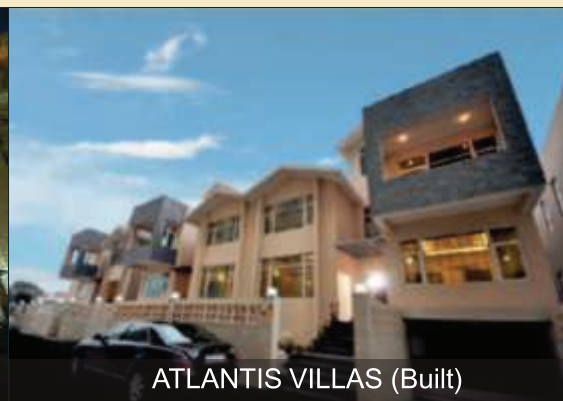

ATLANTIS VILLAS (Built)



RAHEJA PINE GARDEN (Built)



RAHEJA VEDAANTA (Built)



RAHEJA VEDAANTA FLOORS (Built)



RAHEJA VEDAS (Built)



RAHEJA ATHARVA (Built)



RAHEJA SHILAS (Built)



RAHEJA SHILAS FLOORS (Built)



RAHEJA NAVODAYA (Built)



RAHEJA SAMPADA (Built)



RAHEJA REVANTA (Under Construction)



RAHEJA OMA (Under Construction)



NAVIN MINAR (Upcoming)



RAHEJA VANYA (Upcoming)



RAHEJA ARANYA TOWNSHIP (1st Phase Ready for Delivery)



RAHEJA AYANA (Under Construction)



RAHEJA ARABELLA (Under Construction)



RAHEJA ARANYA FLOORS (Under Construction)



RAHEJA MAHESHWARA (Upcoming)



KRISHNA HOUSING (Under Construction)



RAHEJA KRISHNA COMMERCIAL (Upcoming)

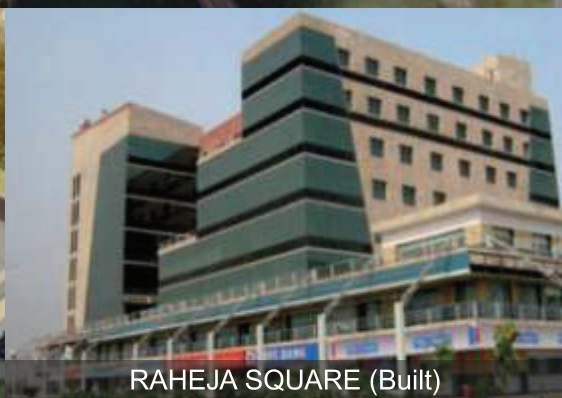

RAHEJA SQUARE (Built)

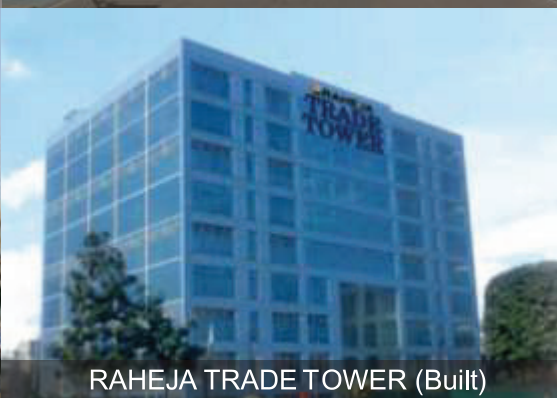

RAHEJA TRADE TOWER (Built)

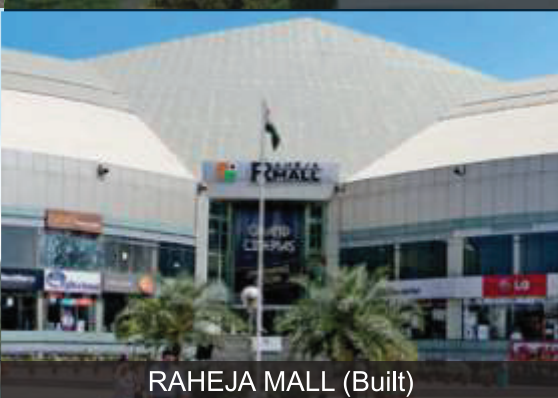

RAHEJA MALL (Built)



HIGHWAY ARCADE (Ready for Delivery)



RAHEJA EDGE (Upcoming)



ENVIRONMENTAL RESPONSIBILITY

Under the guidance of Mr. Navin M. Raheja, a keen naturalist and environmentalist, Raheja Developers abides with strict norms and regulations in their working which makes them develop commercial and residential structures that leaves least environmental footprints. The ecological mechanism used by Raheja's in construction include:

- Water harvesting and reuse of Sewage water for landscaping
- Use of double glazed, thermally insulated and tinted glass for Windows
- Use of photo voltaic cells to generate solar energy
- Use of non toxic biodegradable materials in construction activity
- Use of energy conserving light fittings like CFLs across India.



Raheja Productions, a Raheja subsidiary is a popular producer of films and documentaries based on varied subjects pertaining to today's general issues. The company is also active in developing projects for corporates, NGOs and Government organizations across India.

Played successful seasons on:



Mr. Raheja with Tom Alter, Anchor of "Jungle ki Kahaniyan" by Raheja Productions



A still from the show "Jungle" by Raheja Productions

WILDLIFE AWARDS

- Ramnath Goenka Excellence in Journalism Awards bestowed on Raheja Productions a subsidiary of Raheja Developers that works towards wild life conservation and Environment protection in the category "Environment Reporting"
- Justice BP Banarjee Green Man Award to Mr Navin M Raheja, Producer of "The Rise and Fall of Ustad" at 1st Kolkata International Wildlife & Environment Film Festival 2015
- "Desham Save the Tiger Award " for our Film "The Rise and Fall of Ustad " at 1st Kolkata International Wildlife & Environment Film Festival 2015
- 2rd Prize in 10th Kirloskar Vasundhara International Film Festival for our film "The Rise and Fall of Ustad"
- 3rd Prize in 9th Kirloskar Vasundhara International Film Festival for our film " on losing ground"

112 episodes of our series Wilderness Days have been telecasted on DD National and DD India, currently the longest running series on Indian Wildlife. The series has extensively covered wildlife and environmental issues in India and was particularly popular among wildlife enthusiasts and the youth. Raheja Productions' documentaries have been aired on NGC also.

+918586866824

CORPORATE SOCIAL RESPONSIBILITY

- House of Raheja provide their onsite workforce with all the necessary safety equipment like helmets, safety nets and shoes with resistant soles.
- They provide free wholesome meals once in a week to all the workers.
- Workers on site are trained to improve their efficiency in order to progress and live a more responsible life.
- The company sets up day care centers at every construction site for the children of their onsite workers to provide them with primary education.
- The company provides 3 meals a day, pair of clean clothes and books to read to every child of the workers, a step ahead in the direction of making them a much more responsible citizens of tomorrow.
- Raheja's run Gayatri Sansthan an NGO as a social initiative to educate children from unprivileged class of the society. The institute imparts primary education that includes learning of subjects English, Maths, Hindi and computers. They even train children with yoga and yagna thereby adding virtues to their lives.



Raheja's run Gayatri Sansthan an NGO as a social initiative to educate children from unprivileged class of the society.

CSR AWARDS

- Awarded Redevelopment Project of the Year for Kathputli Colony at Franchise India 7th Annual Estate Award
- Awarded "Redevelopment Project of the Year" for Kathputli Colony, Delhi at 6th Realty Plus Excellence Awards 2014
- Awarded in the category of Corporate Social Responsibility at the Cityscape Awards Real Estate Asia 2010
- Awarded in the category of Social Development and Impact at CIDC Vishwakarma Award 2015
- Awarded "Best CSR Initiative" by NAREDCO's at 12th Convention on "Housing for All - 2022"
- "Best CSR Initiative of the Year" at ASSOCHAM Excellence Awards 2014
- Awarded Silver Category at "3rd Annual Greentech CSR Award 2014".
- Mr Navin Raheja Awarded "Social Entrepreneur of the Year" at Entrepreneur India 2014

IN-SITU SLUM REHABILITATION PROJECT

















Have you ever wondered this colourful spot captured on google image right in the centre of Delhi is about to re write "History of poverty and deprivation in India". Raheja Developers Limited has been awarded the first of it's kind In-Situ Slum Rehabilitation Scheme at Kathputli Colony, spread over 5.22 hectares near Shadipur Depot, by the Delhi Development Authority. This world class facility has been created by Raheja Developers as Transit camp for approx 15000 slum dwellers at Anand Parvat in Central Delhi with complete facilities of toilets, S.T.P, RO drinking water supply, greenescapes, schools etc - a city in itself.



First of it's kind In-Situ Slum Rehabilitation Scheme at Kathputli Colony

OUR ASSOCIATES

We believe in working with global experts so as to offer the best to our esteemed customers. Some of these names are also partnering us in grooming Maheshwara to be the finest valuable luxury homes in India.

 <p>OUR ASSOCIATES</p>	 <p>Arabtec Construction, LLC (UAE)</p> <p>The construction company that built Burj Khalifa. The tallest building in the world. Building Raheja Revanta and shall be building Raheja Ayana</p>	 <p>PERI SKYDECK is German shuttering & scaffolding system which decreases the slab cycle from 20-25 days to 5-6 days, thereby increasing speed of construction and dramatically improving the quality. Being used at Raheja Revanta.</p>	 <p>India's leading construction company Building Raheja Aranya, India's first Smart Green City.</p>
 <p>Joint venture partner in Raisina & Arabella projects</p>	 <p>Meinhardt, Singapore, Designers of Dubai Mall, Marina Bay Sail & Financial Centre. MEP consultants for Raheja's Oma, Dharuhera.</p>	 <p>The largest multiplex chain in UAE. Operating 4 Screen Multiplex at Raheja Mall, Gurgaon.</p>	 <p>20 years old German Facade consultancy company operating in more than 15 countries globally. Designing Facade for Raheja Revanta.</p>
 <p>Thornton Tomasetti of USA Structural Engineers for 1 KM tall Kingdom Tower, Petronas Towers, Taipei 101 etc. Structural consultant for Raheja Revanta.</p>	 <p>Callison, an international architecture firm based in Seattle, Washington. \$ Awarded No. 1 in Retail Design* consistently since 2003 by World Architecture. Designed Navin Minor, New Delhi.</p>	 <p>India's leading construction company Built Raheja Atharva & TATA Raheja Raisina</p>	 <p>One of the 5 largest International architectural firms. Designed Raheja Vanya Group Housing, Gurgaon</p>
 <p>Is an Australian company which is providing Comprehensive Facility Management Solutions for Raheja Projects.</p>	 <p>World's No. 1 luxury company. Supplying Building materials for Raheja Revanta Royalty, Limited Edition Apartments.</p>	 <p>Internationally acclaimed Lessard Design, USA Architects of Trump Parc & Trump Plaza. Designed Raheja Oma, Dharuhera.</p>	 <p>Part of India's largest Hotel chain, the TATA Group. Operating a 100 room Hotel at Raheja Square.</p>



A TREASURE OF FERTILITY PROSPERITY AND
A LAND OF ABUNDANT RESOURCES!

+918586866824