



AN ISO 9001:2015; 14001:2015; 45001:2018 CERTIFIED COMPANY

 +91-8586866824



WE VALUE WHAT WE
PROMISE,

AS YOUR TRUST IS
PRICELESS.

As a responsible company, we understand the importance of Owning a home. So, we ensure that we keep every promise we make, always delivering quality and that too on time. Always upholding our moto.

REALTY. RELIABILITY. RESPONSIBILITY.

Company Backed by IFC - An arm of World Bank



Received Occupancy Certificate of similar projects in Sohna & Karnal



Rera Registration No. :
269 of 2017 dated 09.10.2017
www.haryanarera.gov.in



Rera Registration No. :
RC/REP/HARERA/GGM//423/155/2020/45
RC/REP/HARERA/GGM/424/156/2020/40
www.haryanarera.gov.in



NO COMPROMISE ON OUR ENVIRONMENTAL RESPONSIBILITIES

At Signature Global, we design our buildings following a set of processes and practices that minimize any negative impact on the climate or nature. This, in turn, ensures efficient use of natural resources without unnecessary wastage. For you, this means reducing the maintenance cost while increasing the sustainability of resources.



The COVID-19 pandemic is threatening health & lives.



United Nation Environment Programme has suggested sustainable development goals for Global recovery with Building & Construction as One of the focus areas.



Signature Global has been frontline when it comes to adopting Green Building practices

SIGNATURE GLOBAL IS CERTIFIED AS AN ECO-FRIENDLY ORGANIZATION



For our promise to take care of environment around us or effected by us (directly/indirectly).



We have launched 9 IGBC Gold rated projects under affordable Housing



Independent premium floor projects under Deen Dayal Jan Awas Yojna are all going to be EDGE certified (International Green Certification)

SIGNATURE GLOBAL IS THE DEVELOPER PROVIDING GREEN CERTIFIED HOMES TO THE OWNERS; THROUGH EDGE CERTIFICATION OF ITS PROJECTS.



It is an International standard certification that ensures your green home has definite advantages over traditional homes.

- ✓ Building with environment-friendly, non-toxic material.
- ✓ Construction designs that adapt with surrounding nature.
- ✓ Sustainable use of natural resources.
- ✓ Better indoor air-quality.
- ✓ Emphasis on renewable resources, like solar power.
- ✓ Recycling and reusing domestic byproducts, such as used water.
- ✓ Low maintenance costs resulting in better living conditions.

FEATURES OF GREEN HOMES



Operational energy saving features



Natural ventilation



Optimum window to wall ratio (WWR)



Energy-Efficient walls



High thermal performance windows



Water saving features



Low flow water fixtures (taps, showerheads)



Low flow water closet



Waste water treatment & reuse



Embodied energy saving features



Low embodied energy materials (walls, floor & roof slab, flooring & window frames)



Reflective roof



Rain water harvesting



YOUR ADDRESS
AS CLASSY AS YOU



ULTRA LUXURIOUS
INDEPENDENT FLOORS

GOLF COURSE EXTENSION ROAD



SIGNATURE
GLOBAL CITY 63A
SECTOR 63A, GURUGRAM.

**INDEPENDENT
FLOORS
FOR THE
INDEPENDENT
YOU**



DESIGNED BY PADMA
BHUSHAN ARCHITECT
HAFEEZ CONTRACTOR.





INTERIOR STYLING BY
RENOWNED INTERIOR DESIGNER
SONALI BHAGWATI





Start your Independent Innings at a place as unique as you, at Signature Global City 63 A. One of the most respected leaders in realty, Signature Global offers you high-quality, luxury apartments at Golf Course Extension Road which is spread across 5.0125 acres.





AIRPORT

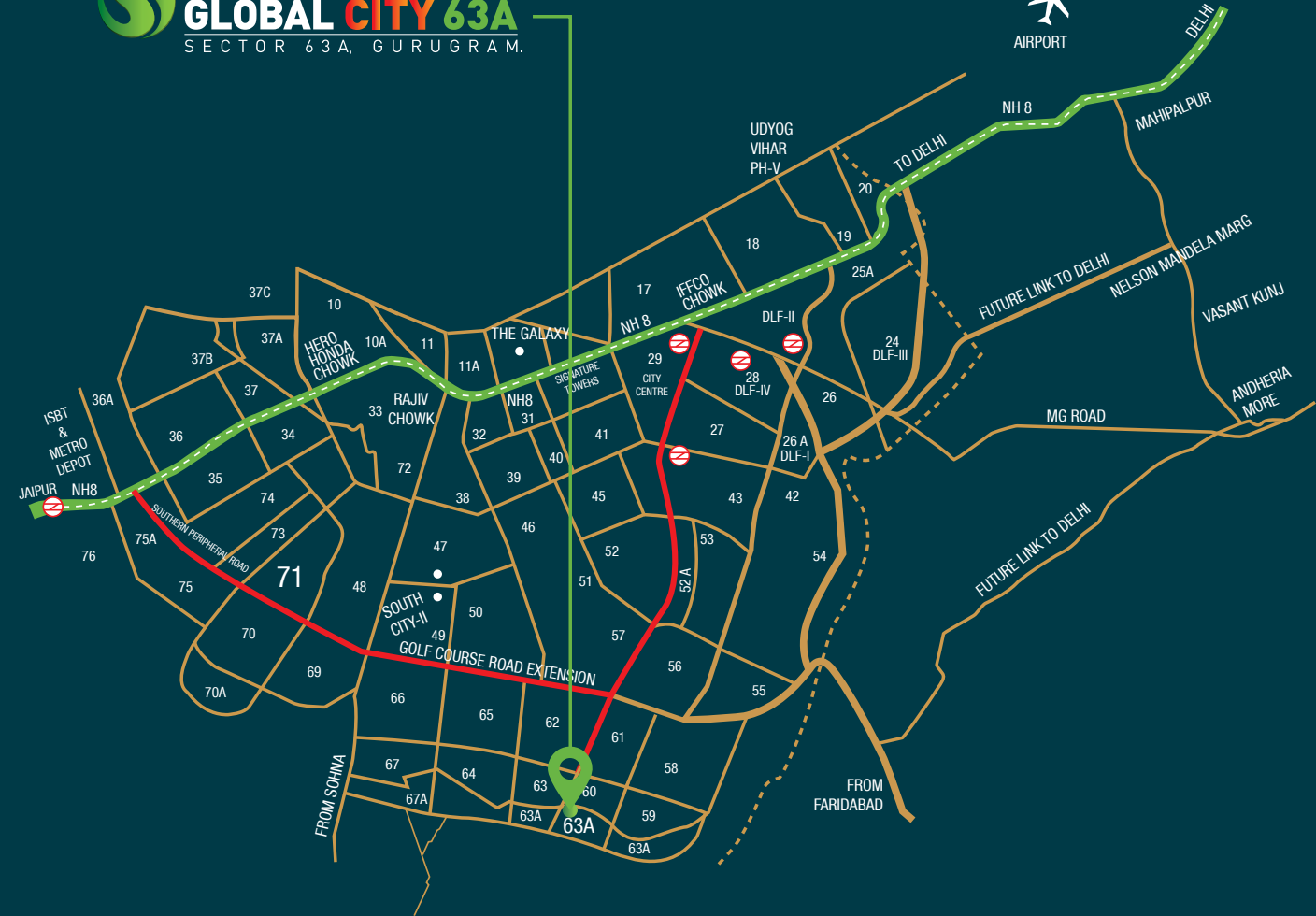

CONNECTIVITY

- Well connected to Golf Course Road, Sohna Road, NH-8, Gurugram and Faridabad Road
- 1.5 KM from the proposed metro station
- 25 KM drive from Indira Gandhi International Airport
- 20 KM drive from Delhi
- 15 KM drive from HUDA City Centre metro station
- Close to Southern Peripheral Road
- Easy access to Delhi through Faridabad Road and MG Road
- The development of the much anticipated Delhi-Mumbai Industrial Corridor shall also help in fueling the already booming infrastructure of this area
- Multiple business hubs and Kadarpur CRPF Camp is in close proximity
- Cycling distance from Capital Cyberspace, Sector-59, Gurugram

CLOSE PROXIMITY TO SOME MODERN CONVENIENCES:

- St. Johannes International School
- VIBGYOR High School
- Shiksha Bharti Public School
- The Shriram Millennium School
- DPS International
- St. Xavier's High School
- Super-specialty hospitals (Medanta/Max/Fortis/Artemis/Paras)
- Multiplexes, shopping malls, hotels

LOCATION MAP

MAP SHOWN HERE IS BASED UPON
GOOGLE MAPS





Gift your Loved ones the Joy of
Signature Life, as Precious as Solitaire.



Drive in to the Solitaire of
Gurugram's Realty.



Get Your Designer Home.
At one-of-a-kind Landscape.



Add the Colour of Nature
to the Uniquely Luxurious Life.



Enjoy a New Wave of Living.
In a Sparkling Pool.



Relax in the Recreation Facility.
In a Landscape Glistening like Diamonds.



A Place
Where Kids can Have all the Fun.



Enjoy the Perfect Blend of Luxury and Health; for a Holistic Living.



Take off on the Swings.
Create Special Memories.



Celebrate the Beauty of Life,
in a Beautifully Sculpted Landscape.

SIGNUM PLAZA 63A
THE RETAIL HUB



A Place Dedicated
to all your Shopping Needs.



A Shopping Arcade
for an upscale experience.



A Landscape for Shopping, Socializing, Leisure and Relaxation.



Welcome your guests
with style and elegance.



Making your inner sanctum the ultimate style statement.



Unleash the culinary artist in you.
In an artistically designed setting.

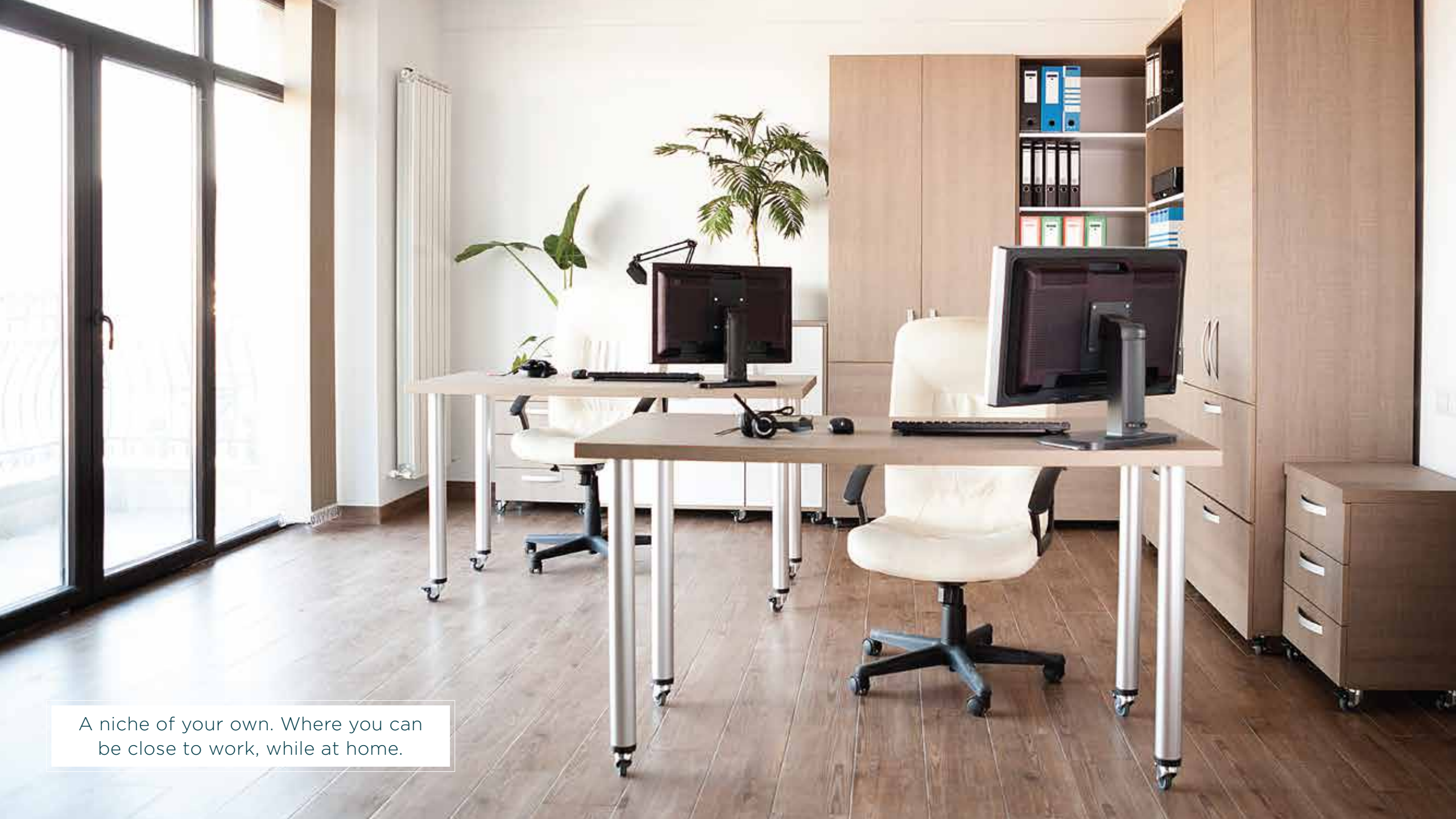

A niche of your own. Where you can be close to work, while at home.

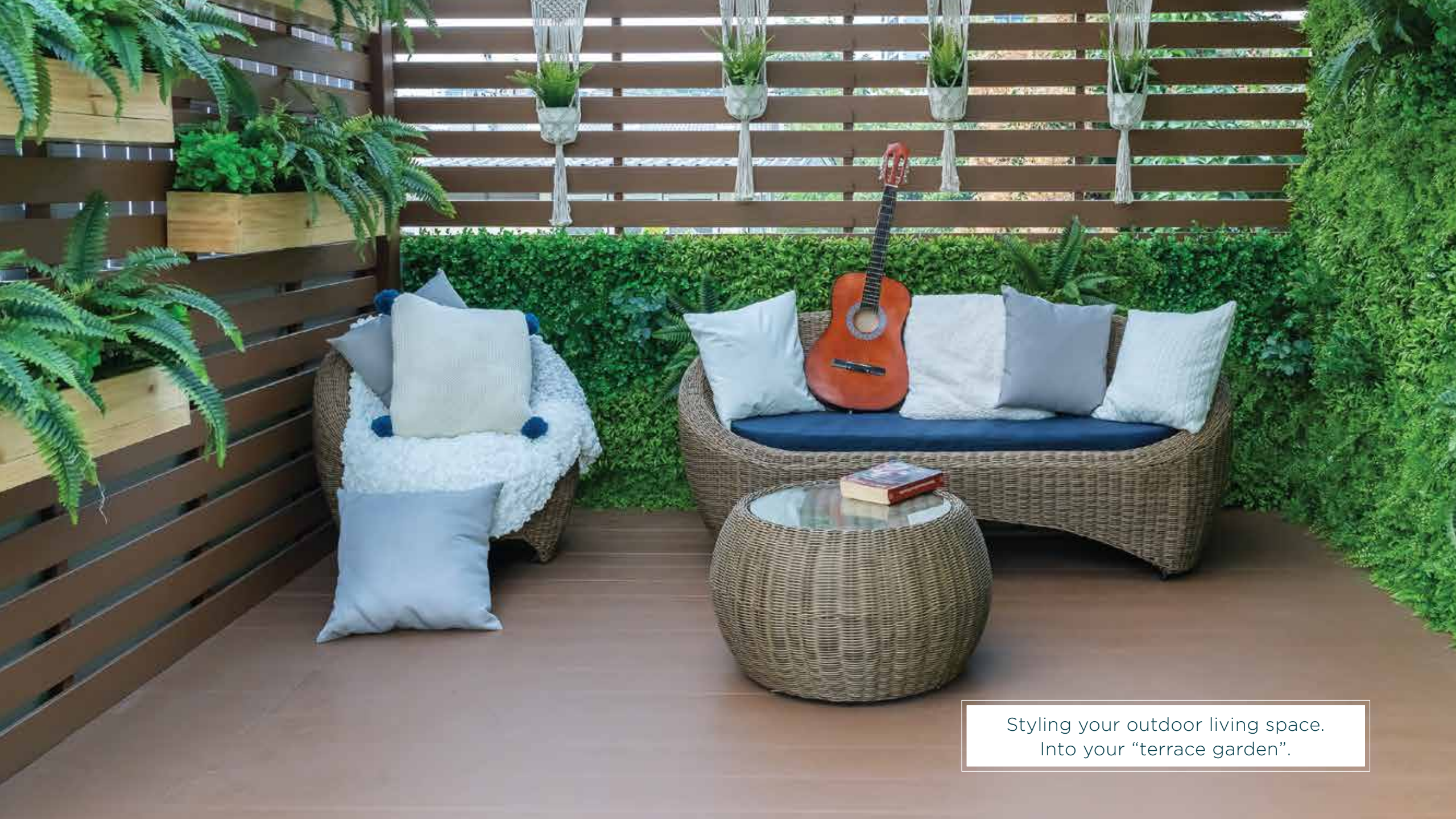

Styling your outdoor living space.
Into your “terrace garden”.



FINE DINING



VIRTUAL REALITY ZONE



TERRACE LOUNGE BAR



SALON



RESIDENT DOCTOR



SPA



YOGA & AEROBICS

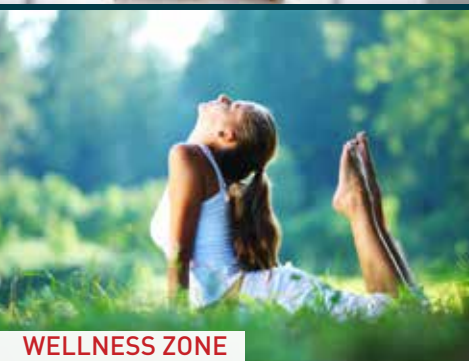

WELLNESS ZONE



GREAT AMENITIES FOR GREATER EXPERIENCES



RECREATIONAL AREA



WORK SPACE



GYMNASIUM



KID'S ZONE



INDOOR GAMES



MULTI PURPOSE HALL



E-LIBRARY



MEETING ROOM

SMART
FEATURES OF
**A SMART
HOME**

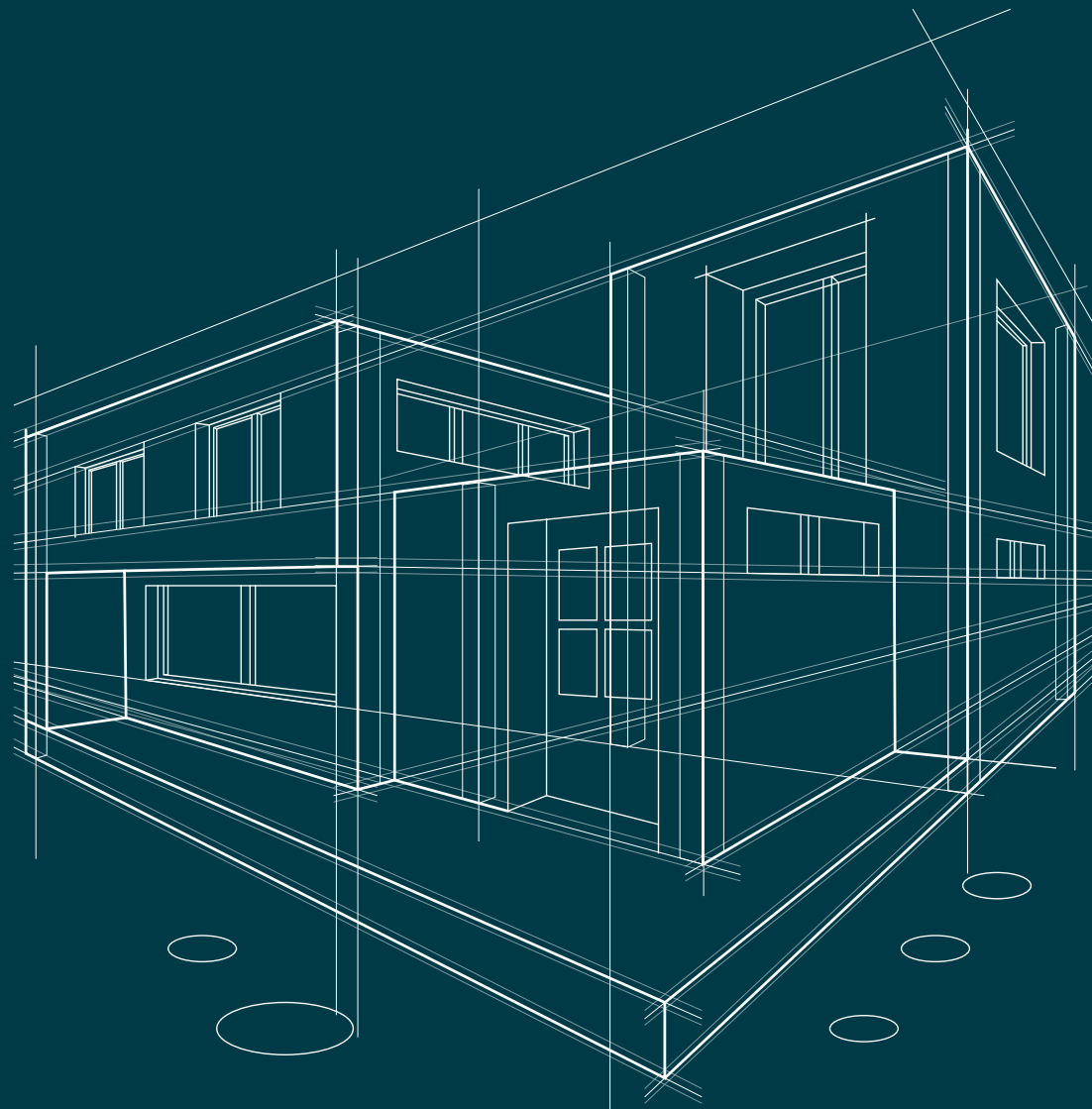



Secured Gated
Community with
Smart Visitor
Management
system.

Provision
for home
Automation**
& FTTH
(Fibre to
The Home)





On Door
Butler
Services

Virtual
Concierge
App





WI-FI
Enabled
Areas

Electric
Car
Charging
Stations





SITE PLAN

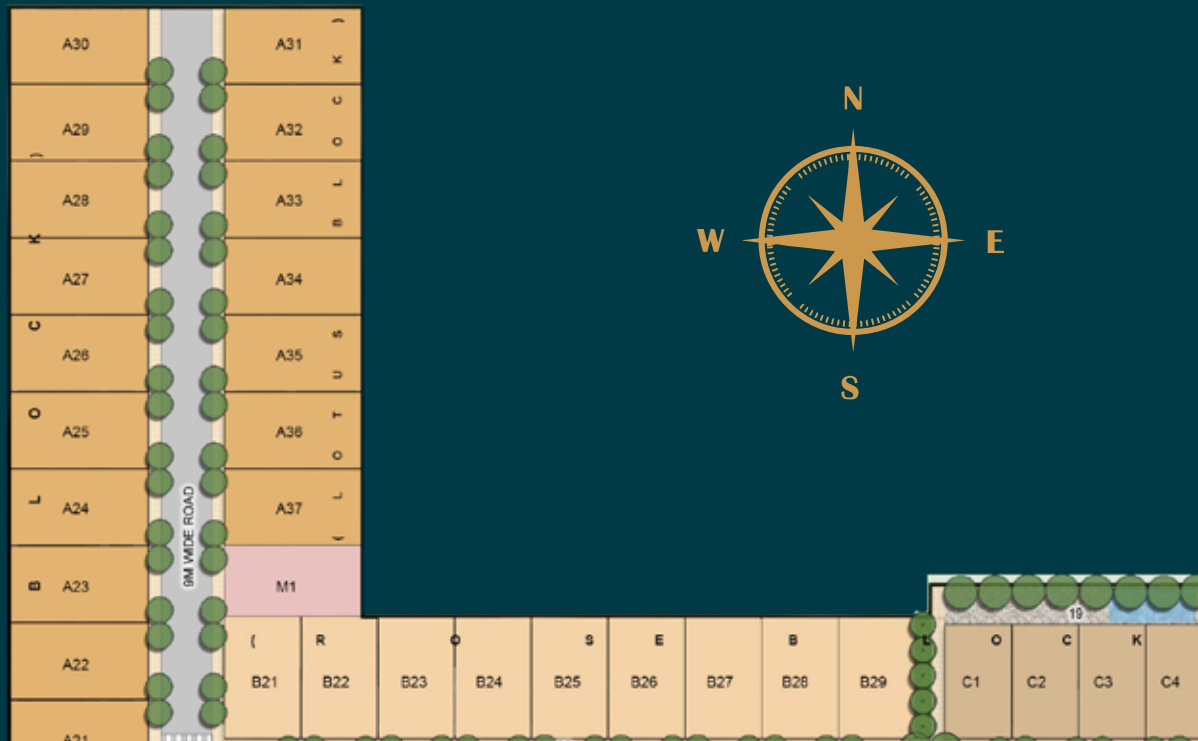

AMENITIES

1. ENTRY/ EXIT PORTAL
2. BRANDING WALL
3. BUS/ TAXI DROPOFF AREA
4. REFLEXOLOGY GARDEN
5. TREE COURT
6. SENIOR CITIZEN AREA
7. GAZEBO
8. SEATING PLAZA
9. OPEN GYM
10. BASKETBALL PLAY COURT



Video
Door
Phone

Digital
Door
Lock





HVAC
VRV

Modular
Kitchen



TYPE - A

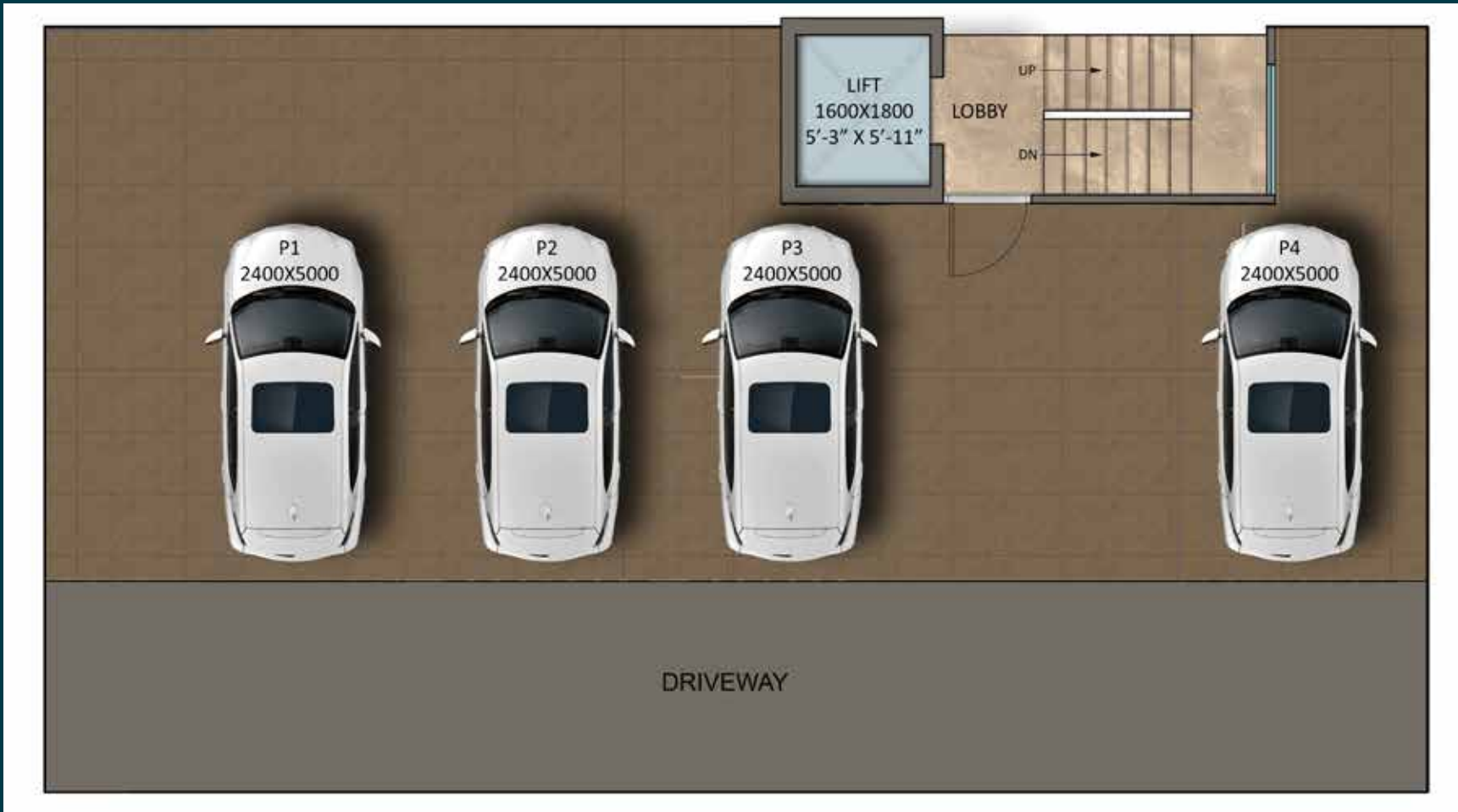

STILT FLOOR PLAN

TYPE - A
3 BHK + 3 TOILET + POOJA ROOM



1ST TO 4TH FLOOR PLAN | SALEABLE AREA : 1470 SQ.FT.

TYPE - A



TERRACE FLOOR PLAN

AREA : 914 SQ.FT.

TYPE - A



BASEMENT FLOOR PLAN

AREA 1 : 304 AREA 2 : 304 AREA 3: 261

TYPE - B

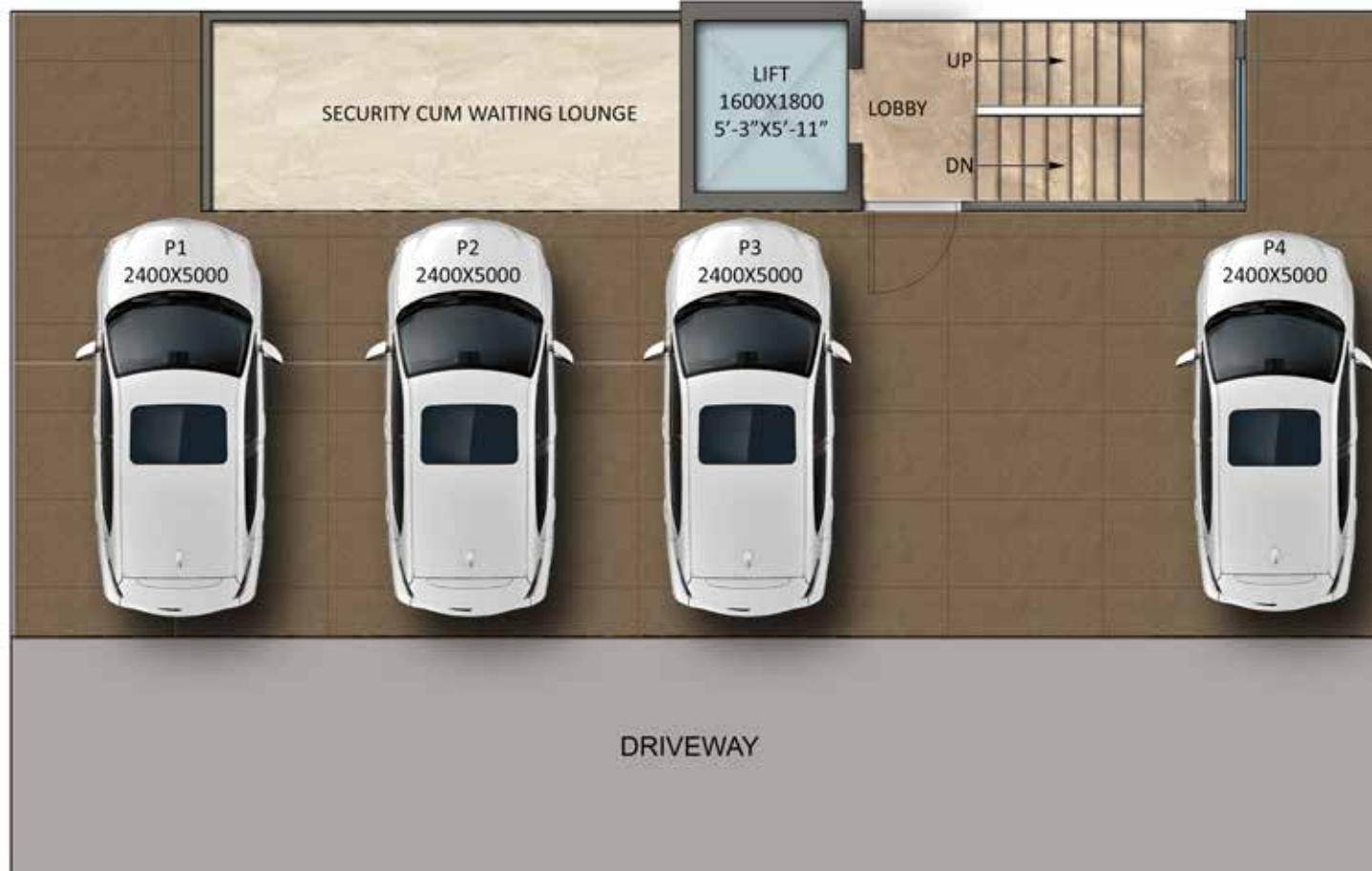

STILT FLOOR PLAN

TYPE - B
3 BHK + 3 TOILET



1ST TO 4TH FLOOR PLAN | SALEABLE AREA : 1305 SQ.FT.

TYPE - B



TERRACE FLOOR PLAN

AREA : 732 SQ.FT.

TYPE - B



BASEMENT PLAN

AREA 1 : 235

AREA 2 : 235

AREA 3: 112

TYPE - C

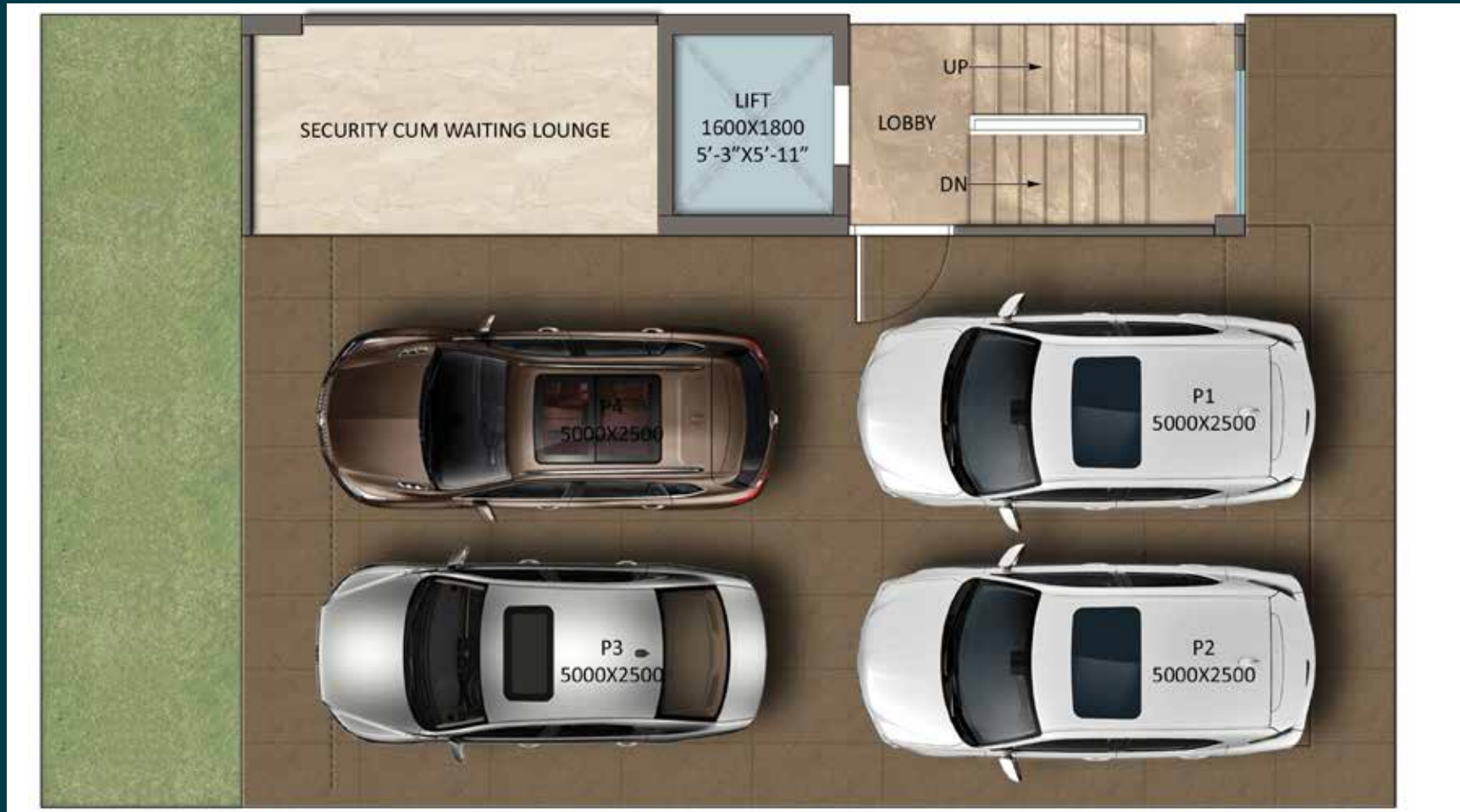

STILT FLOOR PLAN

TYPE - C
2 BHK + 2 TOILET



1ST TO 4TH FLOOR PLAN | SALEABLE AREA : 1050 SQ.FT.

TYPE - C



TERRACE FLOOR PLAN

AREA : 503 SQ.FT.

TYPE - C



BASEMENT PLAN

AREA 1 : 182 | AREA 2 : 167 | AREA 3: 97

SPECIFICATIONS

DRAWING / DINING ROOM



FLOOR
MARBLE FLOORING



CEILING
ACRYLIC EMULSION PAINT/
OIL BOUND DISTEMPER



WALL
ACRYLIC EMULSION

BALCONIES



FLOOR
ANTI-SKID / MATT
FINISH CERAMIC TILES



RAILING
GLASS RAILING

BEDROOM



FLOOR
LAMINATED WOODEN FLOOR



CEILING
ACRYLIC EMULSION PAINT/
OIL BOUND DISTEMPER



WALL
ACRYLIC EMULSION

TERRACE



BRICKBAT COBA OR
WATER PROOFING TREATMENT

KITCHEN



FLOOR
VITRIFIED /
CERAMIC TILES



WALL / CEILING
ACRYLIC EMULSION PAINT/
OIL BOUND DISTEMPER



DADO
CERAMIC TILES 600 MM
ABOVE THE COUNTER



COUNTER TOP
GRANITE STONE



FITTINGS & FIXTURES
ISI MARKED CP FITTINGS
& SS SINK

TOILET & BATH



FLOOR
ANTI-SKID
CERAMIC TILES



WALL
CERAMIC TILES TILL
4FEET / 7'-0" FEET



CEILING
GRID FALSE CEILING



FITTINGS & FIXTURES ISI MARKED
CP FITTINGS, WC & WASHBASIN

DOORS & WINDOWS



MAIN / INTERNAL DOOR FRAME
HARD WOOD / RED MERANTI



INTERNAL DOOR SHUTTERS
BOTH SIDE LAMINATED DOORS



EXTERNAL DOORS & WINDOWS
UPVC/ALUMINIUM POWDER COATED

ELECTRICAL



WIRING
COPPER ELECTRICAL WIRING
THROUGHOUT IN CONCEALED
CONDUIT FOR LIGHT POINTS



SWITCHES / SOCKET
ISI MARKED SWITCHES
& SOCKETS

EXTERNAL DEVELOPMENT



INTERNAL ROADS
INTERLOCKING BLOCKS/
TREMIX CONCRETE ROAD



BOUNDARY WALL
RCC / BRICK WALL
WITH PLASTER &
EXTERNAL WEATHER
PROOF PAINT FINISH



EXTERNAL PAINT
WEATHER PROOF TEXTURE
PAINT IN BUILDINGS

STRUCTURE



EARTHQUAKE RESISTANT
RCC FRAMED STRUCTURE
AS PER SEISMIC ZONE

BEST BRANDS FOR THE BEST EXPERIENCE

TILES

Kajaria

VARMORA

orientbell

SWITCHES

legrand

OSUM

wipro

NORTH-WEST

PAINTS

ap

Dulux

Berger

WOODEN DOORS

Bhutan tuff

rama

KITCHEN SINK

Jayma

CARYSIL

DOOR LOCKS & HANDLES

dorsët

OZONE

Goorej

WIRES & CABLES

Finolex

HAVELLS

POLYCAB

GLASS

SAINT-GOBAIN

AIS

ALUMINIUM DOORS & WINDOW PROFILES

SCHÜCO

TECHNAL

CP BATH FITTINGS

Jaquar

KOHLER

LIFTS

OTIS

KONE

Schindler

LIGHTING

wipro

OSRAM

PHILIPS

CHIMNEY AND HOB

elica

FABER

HVAC VRV

DAIKIN

VOLTAS

SANITARY FITTINGS

Jaquar

KOHLER

hindware

Note : Flooring in mix design of marble, granite and tile. Accordingly, variations in shade and/or size and/or colour and/or design of the tiles, motifs, mica etc. may occur.

All products, names, logos, brands, trademarks are properties of their respective owners. Product of other companies may also be used. However, priority will be given to the aforesaid brands/companies.

SITE PLAN

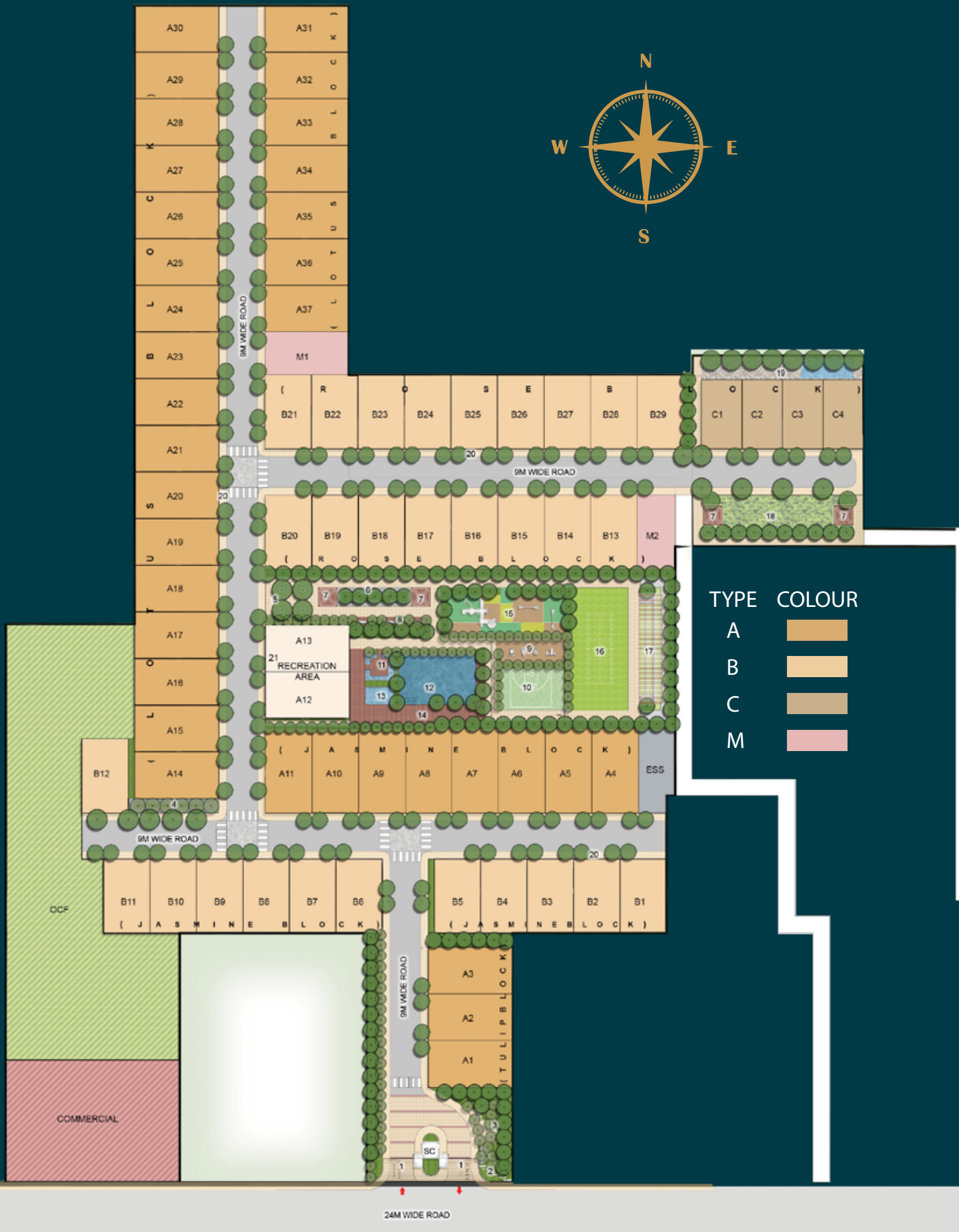
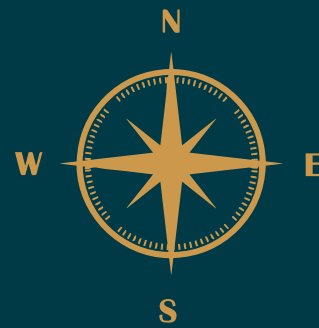

AMENITIES

1. ENTRY/ EXIT PORTAL
2. BRANDING WALL
3. BUS/ TAXI DROPOFF AREA
4. REFLEXOLOGY GARDEN
5. TREE COURT
6. SENIOR CITIZEN AREA
7. GAZEBO
8. SEATING PLAZA
9. OPEN GYM
10. BASKETBALL PLAY COURT
11. DECK WITH BUBBLERS
12. SWIMMING POOL
13. KIDS POOL
14. POOLSIDE DECK
15. KIDS PLAY AREA
16. MULTI PLAY LAWN
17. AMPHITHEATER WITH PERGOLA
18. FRAGRANCE / BUTTERFLY GARDEN
19. PETS PARK/ SPLASH POOL
20. 1.75 M WIDE PATHWAY
21. RECREATION AREA



ABOUT SIGNATURE GLOBAL

We, at Signature Global, believe in the policy of transparency. Though we have created our own distinct identity in the field of real estate, we are working more passionately to maintain and improve our reach in the sector. We emphasize on the core values of reliability, responsibility and global standards with regard to the International Real Estate realm.

The group has outlined its vision for 'India of Tomorrow' with a mission of 'Har Parivar ek Ghar' (a home for every family). With a vision to redefine the current conventions of Indian real estate development by championing excellence in craftsman, planning and service, the company has successfully launched affordable housing projects; all in the prime locations including Gurugram, Sohna and Karnal in Haryana and commercial malls focussing on the interest of customers in Vaishali, Ghaziabad, Uttar Pradesh and Sohna, South of Gurugram. The company has successfully delivered Signature Global Solera, Synera, Andour Heights, Grand IVA, Orchard Avenue, Solera 2, The Serenas, Roselia 2 and Signature Global Park 2&3 in Gurugram and offered possession of Signature Global Sunrise in Karnal months before the expected time of delivery.

Each residential project is complimented with one branded retail hub christened as Signum. The hallmark of these projects are ideal location, impeccable quality of construction with excellent amenities at reasonable prices. They are unique in terms of planning, design, quality, workmanship, transparency, customer delight and service. We have ushered in best global practices of transparency and professionalism, with 'think global, act local' approach, doing product development as per the needs of our valued consumers. We have introduced highly advanced global green building certification IGBC, which provides a solution to capitalize on the value of green buildings by promoting benefits to customers while protecting environment.

We are deploying cutting edge technology and best project management techniques to achieve scale and efficiency to boost affordability. Signature Global works with a team of experienced

architects, master planners and designers who are among the best in the industry. We had partnered with several leading National and International institutions like IFC (a sister organization of the World Bank and a member of the World Bank Group), HDFC CAPITAL, ICICI Prudential etc. and takes pride in growing its reach to customers by seeking direct online applications.

Leading a team of highly enthusiastic professionals is always an enjoyable task. The same becomes even more motivating when the society starts recognizing and rewarding your efforts. In the last couple of years, we have won several awards from prestigious media houses for our outstanding contribution to the real estate.

- 'Haryana's Icons' and 'Emerging Developer' by Times of India.
- 'Business Leaders in Affordable Housing' by ASSOCHAM.
- 'Best LIG Housing Project' for Solera by PMAY Empowering India, 2019.
- 'Electronic Media Campaign of the Year' and 'Sustainable Business Leader of the Year' by Realty Plus, 2019.
- 'Affordable Housing Project of the Year' for Synera at 12th 'Realty+' Awards
- 'Developer of the Year', Residential and Digital Media Campaign of the Year' in 2020 at 12th 'Realty+' Awards
- 'The Developer of Affordable Housing of the Year Award' by ASSOCHAM at 'Realty and Sustainability Confluence and Awards', 2020.
- 13th Annual Estate Awards 2021, Affordable Housing Property of the Year - (National) Golf Greens-79
- 13th Annual Estate Awards 2021, Best Affordable / Budget Housing Developer of the Year – Residential (National)
- 'Developer of the Year - Residential at the 13th 'Realty+ Excellence Awards', 2021, NORTH.

- 'The Business Leadership Awards', 2021, under 'Brand Excellence in Real Estate and Construction' category.
- 'Excellence in Indian Real Estate' award at 'UDAAN - Dare to Dream' by Zee Hindustan.
- 'Sustainable Business Leader of the Year' to Mr. Pradeep Aggarwal at the 13th 'Realty+ Excellence Awards', 2021, NORTH.
- 'Affordable Housing Project of the Year' to Grand IVA and 'Project Launch of the Year' to Signature Global City 37D at the 13th 'Realty+ Excellence Awards', 2021, NORTH.
- 'The 8th IGBC Green Championship Awards' under the category of 'Developer Leading the Green Affordable Housing Movement in India'.
- India's Most Sustainable Companies Published in the 2nd edition of BW BusinessWorld in association with Sustain Labs Paris
- Real Estate - Affordable Housing Developer of the year by Times Business Awards North 2022

Recently, we have been honoured by Directorate of Town and Country Planning (DTCP) and Haryana Real Estate Regulatory Authority (HARERA), Panchkula and Gurugram, with the following awards:

- Facilitated for delivery of affordable housing Project within a three-year period, after obtaining occupancy certificate; Presented by Sh. Manohar Lal Khattar, Hon'ble Chief Minister of Haryana.
- Facilitated for completion of DDJAY project within a record time frame of less than one and a half years; Presented by Sh. Manohar Lal Khattar, Hon'ble Chief Minister of Haryana.

We have also got ISO 9001:2015; 14001:2015; 45001:2018 Certification. We are indeed proud of our achievements and thankful to our highly enthusiastic professionals for their immense support.

+91-8586866824

