

**HILL TOWN A WORLD OF ITS OWN**

Experience expansive mountains, nature, clean air and greenery at your very own home at Hill Town, giving a whole new dimension to luxury living with this one-of-a-kind project. At Hill Town space abounds everywhere, and the super sized rooms with well appointed windows provide uninterrupted views of the spectacular Aravalli range. From independent villas & plots, to premium residential housing for the social ones or independent floors for those who value their privacy over anything else, we have something for all. Living at Hill Town, has its own share of perks. A lifestyle that resembles a resort, retail & commercial establishments, security of a gated community and the camaraderie of the like-minded. Welcome to your new life!



**WORLD CLASS CLUBHOUSE AND RECREATIONAL FACILITIES**

Magnificent living requires magnificent gestures. The clubhouse at Hill town stands as a testament to this statement, offering both the sports enthusiasts and the leisure seekers the avenues to pursue their interests with equal passion. With a focus to provide you with a green and serene lifestyle, everything here is imbued with a green approach ensuring a well balanced lifestyle for you and your family. Mini theatre, cafeteria, library cum reading lounge, swimming pool with a separate kids pool & a world class, well-equipped gymnasium are just a few things that will keep you engaged and at the same time, in the pink of health. Thereby keeping to our promise of a life replete with fun and bliss.



Mini theatre | World class gymnasium | Badminton courts | Tennis courts | Squash courts | Reading lounge cum Library | Steam & massage | Yoga & meditation pavilion | Cafeteria | Multi-purpose party arena | Kid's play area | Indoor games area with snooker, table tennis & much more

**IF THE ABOVE WEREN'T ENOUGH, WE THOUGHT OF ADDING A FEW MORE**

Golf putting | Elder's corner | Organic farming | Rock climbing | Jogging tracks | Cycling tracks | Cricket pitches | Landscaped gardens

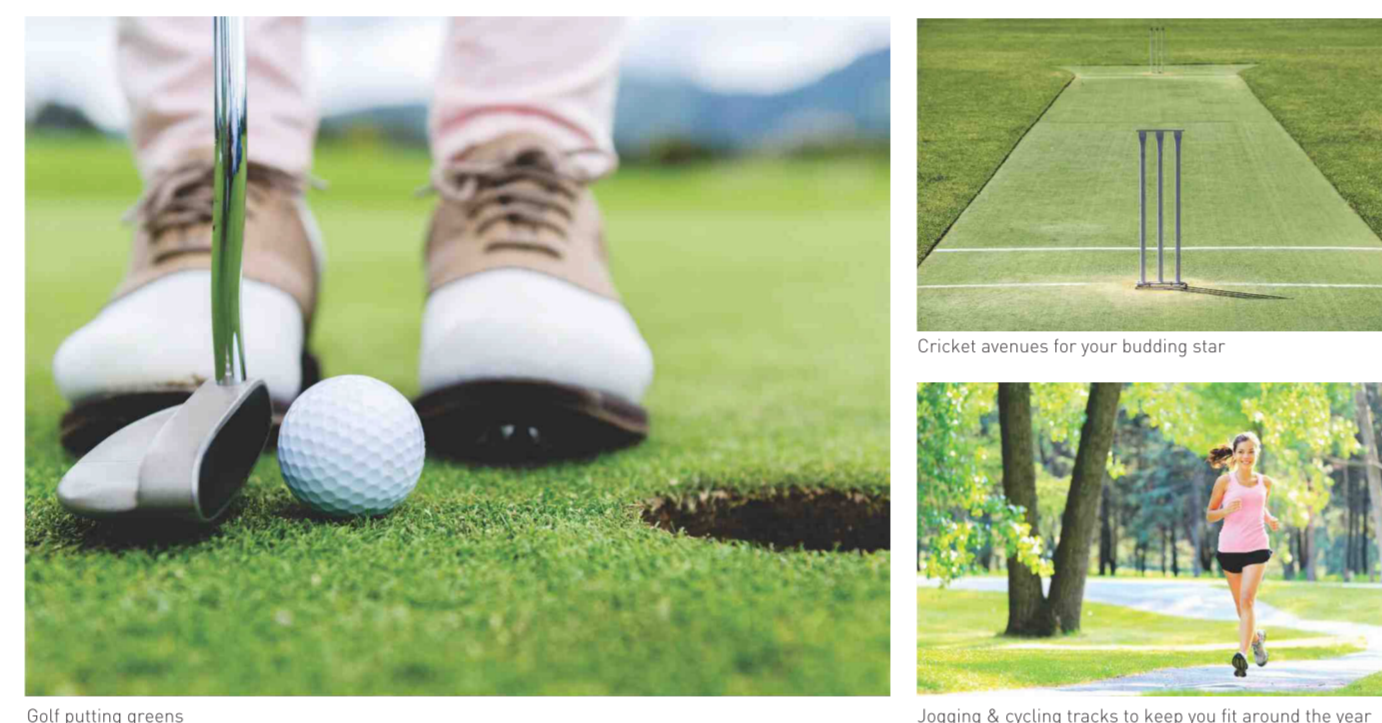

A premium Hill View residence is your home in the lap of nature. A part of the lush hill area development, these residences are the perfect ode to nature inspired living. With the majestic hills greeting you each morning to mesmerizing sun sets, your charmed life begins here with peace and tranquility unlike any other. Come, indulge in something never heard of.

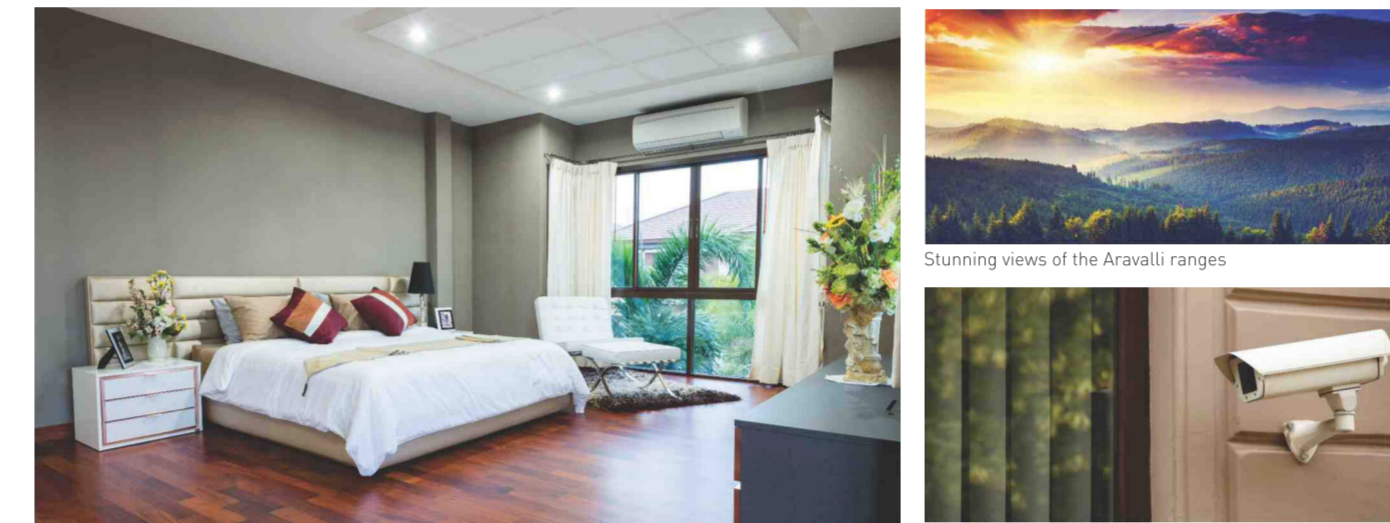

**SPECIFICATIONS**

Structure	Floor	Earthquake resistant, RCC framed structure with external brick / block walls
Living / Dining Room / Drawing Room	Floor	Water / Spanish Designer Vitrified Tiles
	Walls	Cement plaster with POP painting with plastic emulsion paint or texture finish.
Kitchen	Walls	OPB with Organic Elements
	Countertops	100% natural granite to be provided in the living room
Master / Bedroom	Floor	Waterproof Designer Tiles / Woodless Laminate Flooring
	Walls	Cement plaster with POP painting with plastic emulsion paint or texture finish.
Other bedroom(s)	Floor	Waterproof Designer Tiles / Woodless Laminate Flooring
	Walls	Cement plaster with POP painting with plastic emulsion paint or texture finish.
Servant / Utility Rooms	Floors	Ceramic Tiles / Wall dado with ceramic tiles
	Walls	Cement plaster with OPB
Doors	Entrance doors	Elegantly designed 8 ft. high entrance door with polished hardwood frame having European style moulded shutter with high quality imported Indian hardware fittings.
	Internal doors	Spacious wooden frame with large glass sliding glass door shutter / Aluminium / UPVC Sliding Doors

Room	Specification	
Washroom	Walls	Spanish tiles in walls till ceiling height for master washroom, all other washrooms will have wall tiles upto 7ft. to be provided to protect emulsion paint.
	Floor	Master / Spanish vitrified tiles or equivalent flooring for master toilet, all other washroom will have ceramic tiles.
	Features	Premium Quality WC and washbasin in matching color/costs. Single level CP fittings. Roflex/paper or equivalent. All the washrooms will have exhaust fan, mirror, towel rack, rod & rmg accessories. For specially designed Master Washroom, tubula bath, mirror with wall mounted vanity lighting & mirror.
Kitchen	Walls	OPB / Tiles up to 7ft.
	Floor	Organic Elements
	Countertops	Finishing of kitchen or equivalent. Double level stainless sink with drain board
	Grilles	OPB
Balcony	Floor	Waterproofing / 10mm Tiles
	Walls & ceiling	Acrylic emulsion / Organic Elements / Paros
	Grilles	OPB
Lift Lobby / Corridors	Floor	Waterproof / Vitrified Tiles
	Walls	Organic Elements / Paros
Storage	Floors	Waterproof / Spanish Flooring
	Walls	Waterproof / Paros
Stair	Floors	Heavy duty anti-slip tiles / paros / ceramic tiles
	Walls	Waterproof / Paros
Facilities	Power & Water	Power & Water: High speed elevators, treated water supply, adequate basement parking, landscaped areas, with quartz benches, tennis court, pedestrian path, jogging track, entrance sign area and car wash stand.
	Security	24x7 Security
General	Construction	UPB / UPB / UPB / UPB
	Electrical	200% excess load on electrical services and appliances.
	Plumbing	Modular ramp with traps / sockets (ground or equivalent) / MCBS, copper wiring.
	Security	Two wall light fixtures in each of living, entry / lobby and bedrooms.



**TYPICAL UNIT PLANS**

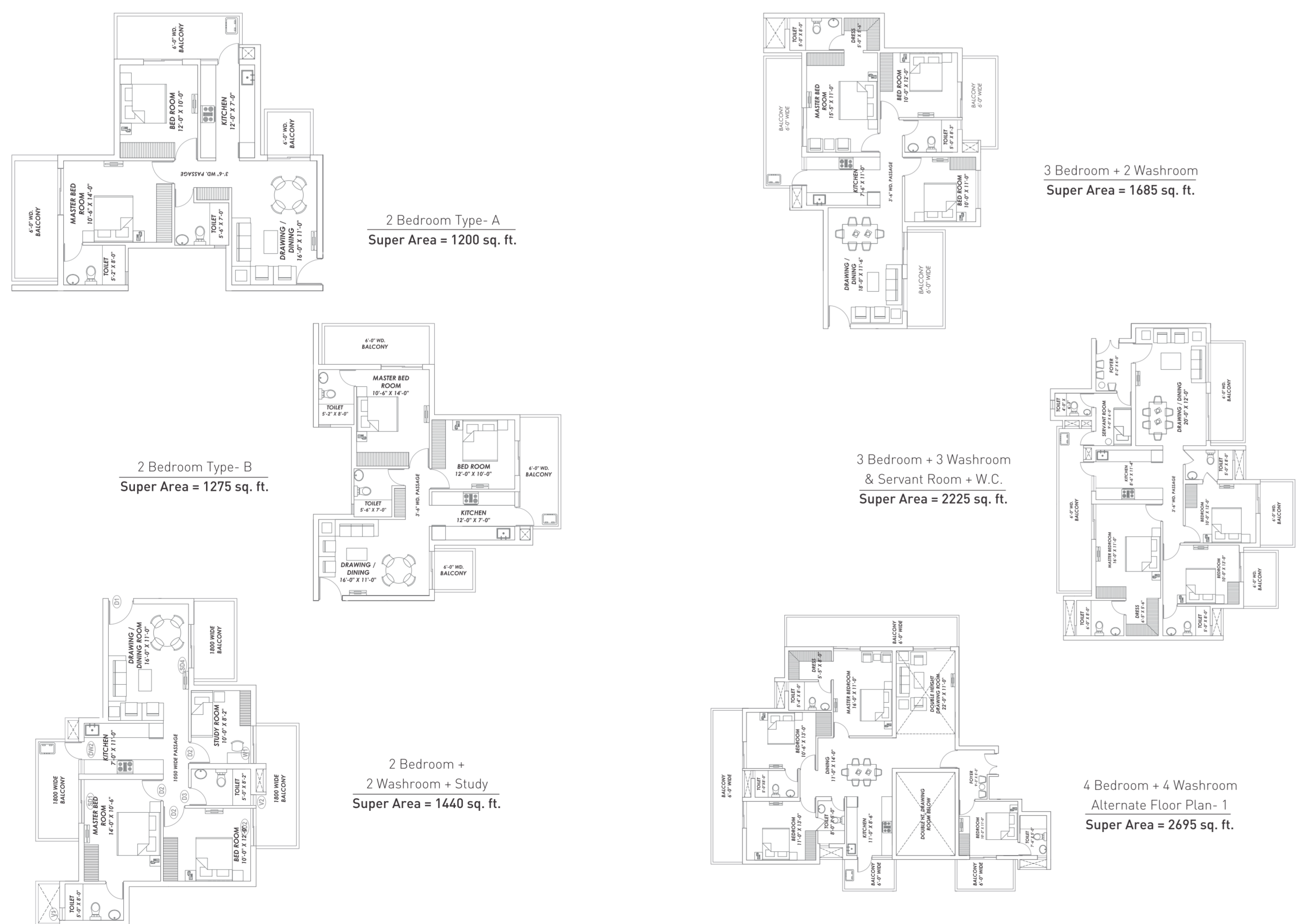

**ABOUT US**

Supertech Ltd. - one of India's leading real estate developers came into inception close to 25 years ago. The company has been instrumental in redefining home buying for any customer around the country. With more than 40,000 satisfied customers & more than 20,000 residences delivered, the company is scaling new heights each day with more than 36 ongoing projects in different locations around the country. With such scale and size comes an opportunity to redefine oneself each day. Global partners like Arman Cass, The Studios - UK, Disney & ACC are but a few of the coveted names in the list that the company boasts of today. Like the pre-cap technology group, the company is fast diversifying while also supporting various causes like Kaksha - an education initiative for the under-privileged.

**KEY HIGHLIGHTS:**  
**Ongoing developments:**  
 North View, Sector 74, Noida | DRB, Sector 74, Noida | Supermaxia, Sector 94, Noida | E-Square, Sector 96, Noida | The Ramana, Sector 118, Noida | Hill Town, Sector 2, Gurgaon | Sohana Road | Phase, Sector 88, Gurgaon & many more  
**Landmarks Delivered:**  
 34 Pavilion, Sector 34, Noida | Capetown, Sector 74, Noida | Eco Village I - Greater Noida | Eco Village II - Greater Noida | I | EcoVill, Sector 131, Noida Expressway | Supertech Emerald Court, Sector 93 A, Noida Expressway & many more

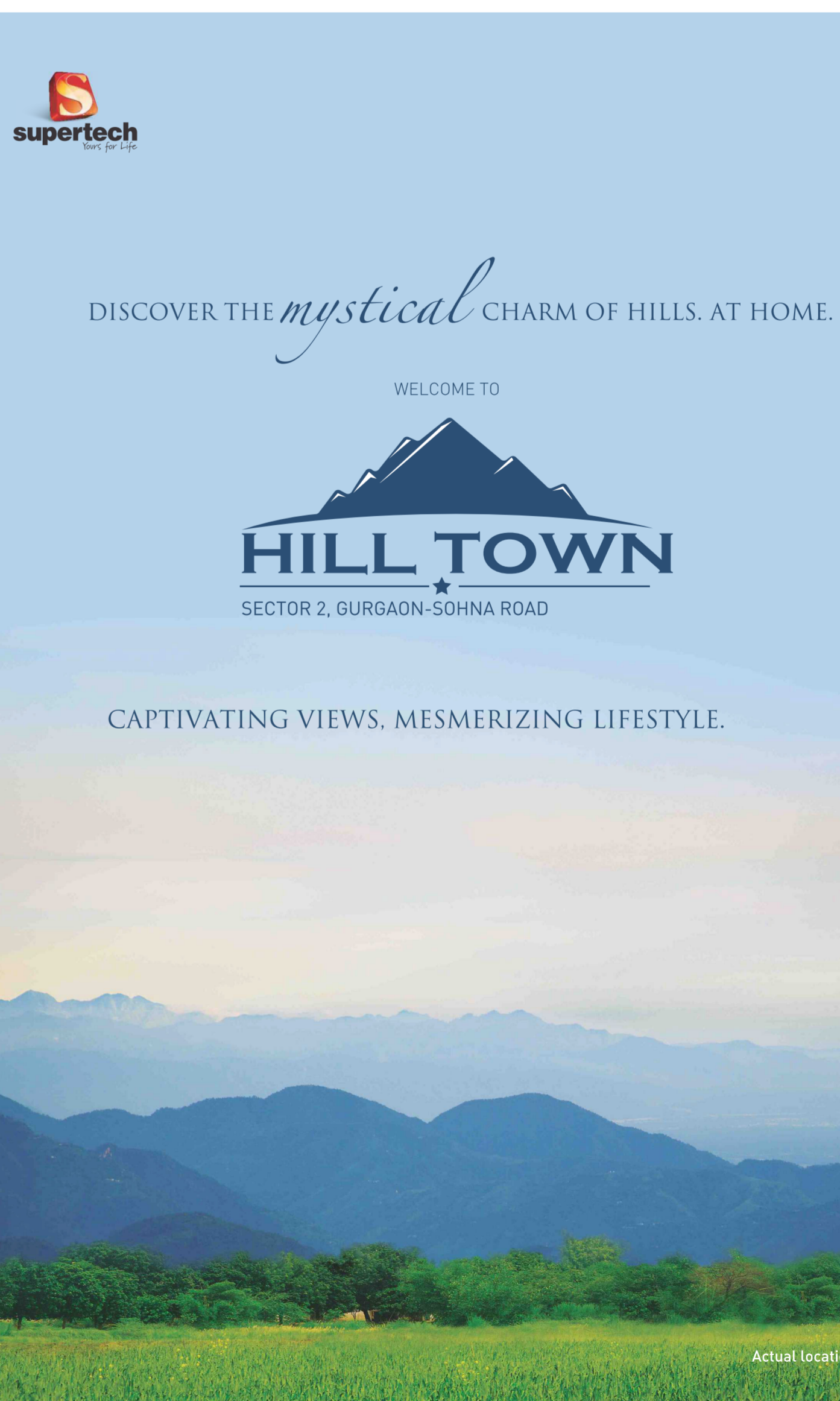

**+918586866824**