

**A REMARKABLE
MIXED LAND USE DESTINATION,
SPREAD ACROSS 3 ACRES
WITH A 200 FT. WIDE FRONTAGE.**

PARK STREET

Developed by VSR

OFFICE SPACES
5, 6, 7, 8 & 9TH FLOOR

ENTERTAINMENT ZONE
3RD & 4TH FLOOR

FOOD STREET
2ND FLOOR

HIGH STREET
RETAIL:
G + 1st FLOOR



+918586866824

Artistic Impression

**THE THREE SIDE OPEN
DEVELOPMENT RIGHT ON
SOUTHERN PERIPHERAL
ROAD.**

PARK STREET

Developed by VSR



+918586866824

Artistic Impression

**ASSURED FOOTFALL FROM THE
ADJOINING RESIDENTIAL ZONE WITH
OVER 10,000 RESIDENT FAMILIES
IN THE PRIME GROUP HOUSING AND
TOWNSHIP PROJECTS BY
RENOWNED DEVELOPERS.**

PARK STREET

Developed by VSR



+918586866824

Artistic Impression

THE LOCATION ADVANTAGE



STRATEGICALLY LOCATED IN SECTOR 85

RIGHT ON SOUTHERN PERIPHERAL ROAD

**WITHIN WALKING DISTANCE
OF PROPOSED METRO STATION**

**SURROUNDED BY PRIME RESIDENTIAL
GROUP HOUSINGS AND TOWNSHIPS**

**IN CLOSE VICINITY
OF THE INSTITUTIONAL CORRIDOR**

**3 KM FROM NH 8,
ISBT & MRTS DEPOT**

**20 MINS
DRIVE FROM IFFCO CHOWK**

**35 MINS
DRIVE FROM IGI AIRPORT**

**40 MINS
DRIVE FROM DHAULA KUAN**



THE CATCHMENT AREA

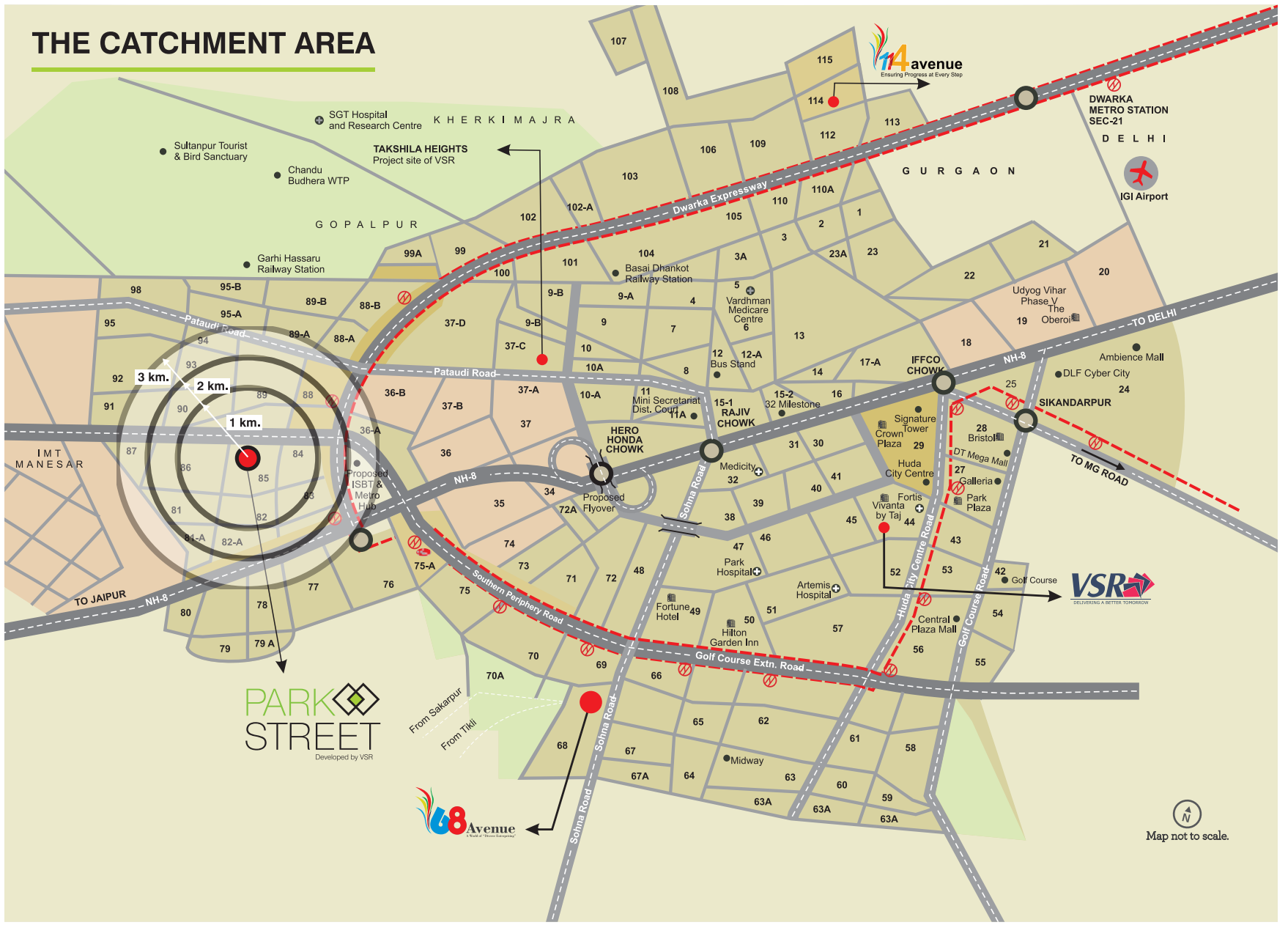

**THE ONLY COMMERCIAL
DESTINATION WITHIN THE
PRIME RESIDENTIAL ZONE THAT
OFFERS A PLETHORA OF
LIFESTYLE AMENITIES.**

PARK STREET

Developed by VSR

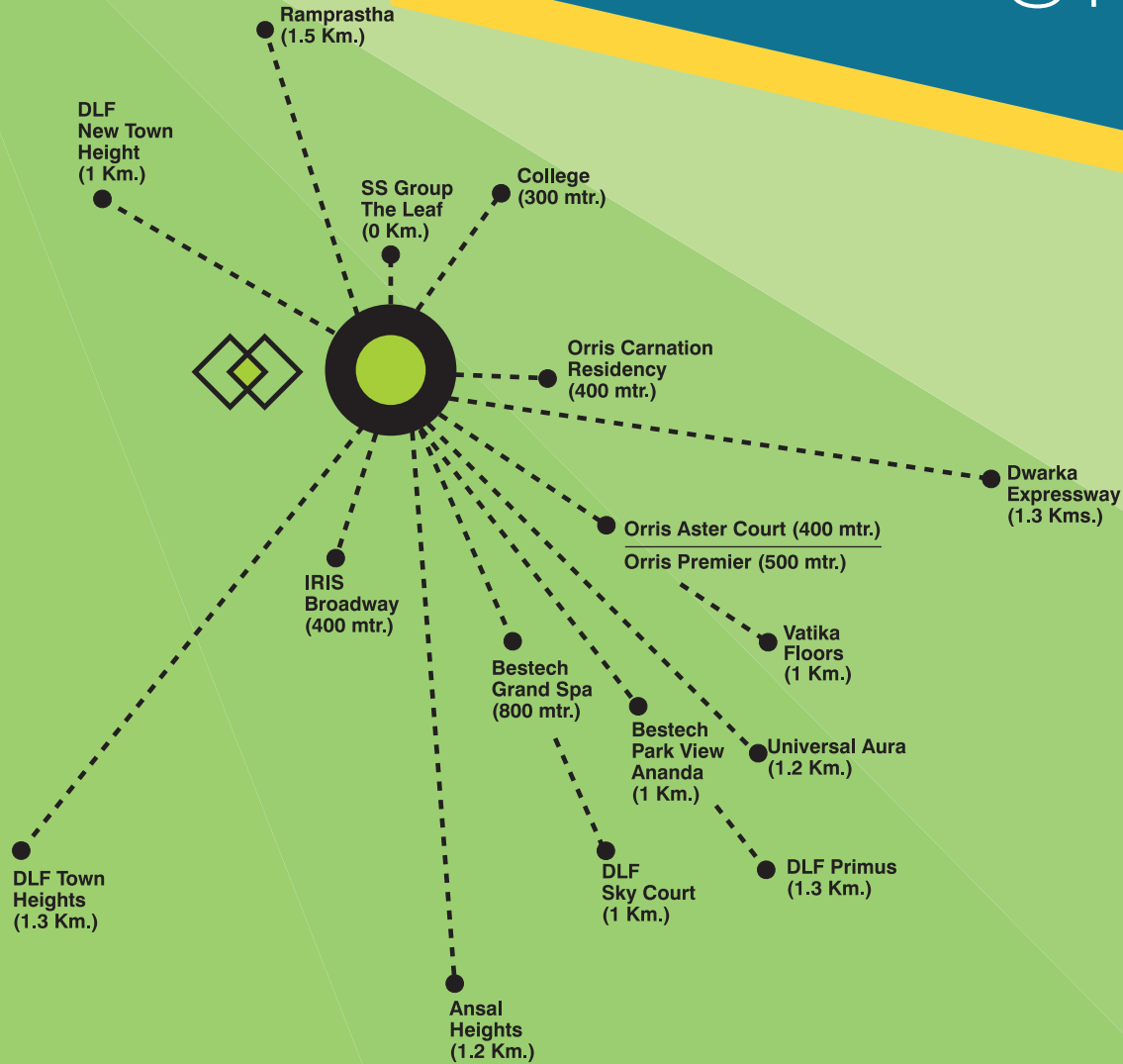

+918586866824

HIGH STREET RETAIL

A photograph of two women with long dark hair in a clothing store. They are looking at a piece of clothing on a rack. The woman on the left is smiling and looking towards the woman on the right. The background is filled with colorful clothing items on shelves and racks. A semi-transparent blue and yellow geometric overlay is present on the right side of the image.

SPREAD OVER G+1ST FLOOR

**MAXIMUM UNITS
OPEN TOWARDS CENTRAL ATRIUM**

**DOUBLE HEIGHT RETAIL
SHOPS WITH LOW MAINTENANCE**

**STREET LEVEL ENTRANCE OVERLOOKING
PEDESTRIAN WALKWAY**



**HIGH SPEED
ELEVATORS AND ESCALATORS**

MULTI LEVEL CAR PARKING

**24X7 POWER BACK UP CCTV
SURVEILLANCE**

+918586866824

FOOD STREET



**SPREAD OVER
2ND FLOOR**

**MULTI CUISINE RESTAURANTS, CAFES
ICE CREAM KIOSK AND STREET FOOD ZONE**

**FOOD COURTS THAT
OFFER VALUE FOR MONEY MEALS**

**ASSURED FOOTFALL FROM THE CORPORATE
AND RESIDENTIAL NEIGHBOURHOOD**

ENTERTAINMENT ZONE



SPREAD OVER 3RD AND 4TH LEVEL

FUN FILLED GAMING ZONE

SPA AND FITNESS CENTRE

DIRECT ACCESS TO CENTRAL ATRIUM

**ASSURED FOOTFALL FROM THE CORPORATE
AND RESIDENTIAL NEIGHBOURHOOD**

MODERN OFFICE SPACES

The image features a modern office interior with large glass windows overlooking a city skyline at sunset. Silhouettes of several business professionals are visible, some standing and talking, others walking. The scene is lit with warm, golden light from the setting sun, creating a professional and dynamic atmosphere. A large, stylized graphic element, resembling a mountain or a stylized 'A', is overlaid on the right side of the image, with yellow and blue colors.

**MODERN COMPACT
OFFICE SPACES**

**STATE-OF-THE-ART
CONFERENCE ROOMS**

**AMPLE
PARKING SPACE**

**WI-FI
ENABLED BUILDING**

+918586866824



**ADVANCE FIRE SAFETY
AND PREVENTION SYSTEM**

**24X7 POWER BACKUP AND CCTV
SURVEILLANCE**

HIGH SPEED ELEVATORS

+918586866824

PARK STREET

Developed by VSR



GROUND FLOOR PLAN (RETAIL)

PARK STREET

PROJECT
PROPOSED MIXED USED
INFRASTRUCTURE
AT SECTOR - 85, GURGAON

PROMOTERS
VSR INFRATECH PRIVATE LIMITED

ARCHITECTS
SANJIV TANDON ARCHITECTS
GURGAON



FIRST FLOOR PLAN (RETAIL)

PARK STREET

PROJECT
PROPOSED MIXED USED
INFRASTRUCTURE
AT SECTOR - 85, GURGAON

PROMOTERS

VSR INFRATECH PRIVATE LIMITED

ARCHITECTS

SANJIV TANDON ARCHITECTS
GURGAON

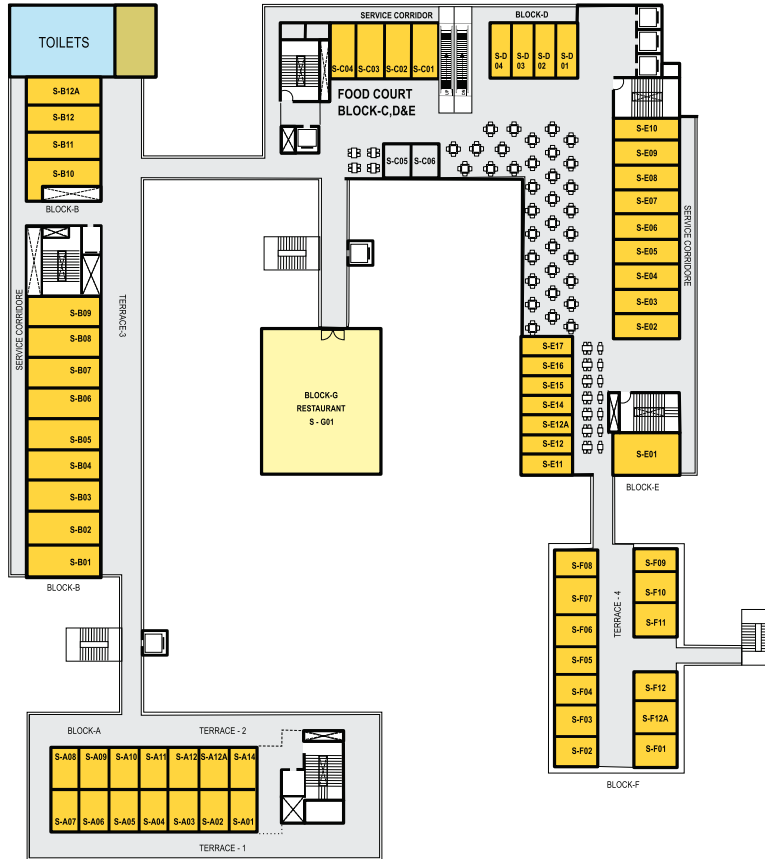

SECOND FLOOR PLAN (FOOD STREET)

PARK STREET

PROJECT
PROPOSED MIXED USED
INFRASTRUCTURE
AT SECTOR - 85, GURGAON

PROMOTERS

VSR INFRA TECH PRIVATE LIMITED

ARCHITECTS

SANJIV TANDON ARCHITECTS
GURGAON



DELIVERING A BETTER TOMORROW

VSR Infratech Pvt. Ltd., a leading real estate developer, is committed to provide unrivalled infrastructural solutions to redefine the industry standards with its every project.

With focus on astute detailing and delivering timely developments the company focuses on building an environment though a culture which embraces a trust based approach and builds a lasting relationship with all the associates and customers.

At VSR we believe in investing in technology to deliver excellence through a highly dedicated team of professionals to ensure best constructional practices.

+918586866824